

中西區區議會範圍內適合綠化或社區用途的臨時空置政府土地(截至2017年06月30日為止)**Temporary Vacant Government Sites Available for Greening / Community Uses within Central and Western District Council Boundary (as at 30 June 2017)**

港島西及南區地政處 編號  District Lands Office/HKW&S Reference No.	位置  Location	面積(約) 平方米  Area (m <sup>2</sup> )	估計可使用時期  Estimated Available Period	土地狀況  Site Conditions	備註  Remarks
DLOHKW&S005	山頂白加道前食物環境衛生署公廁的政府土地  Government land at former FEHD toilet site at Barker Road, Peak	9.40	約2至3年  about 2 to 3 years	(a) 平地 / 傾斜 (b) 只供行人出入  (a) Flat/ Sloping (b) pedestrian access only	(a) 土地長遠用途(綠化地帶)  (a) Long term use (Green Belt)
DLOHKW&S013	上環城皇街的政府土地  Government land at Shing Wong Street, Sheung Wan	44.00	約1至2年  about 1 to 2 years	(a) 平地 (b) 只供行人出入  (a) Flat (b) pedestrian access only	(a) 土地長遠用途(綜合發展區)  (a) Long term use (Comprehensive Development Area)
DLOHKW&S024	山頂干德道24號前面的政府土地  Government land fronting No. 24 Conduit Road, Peak	114.00	約2至3年  about 2 to 3 years	(a) 平地 (b) 只供行人出入  (a) Flat (b) pedestrian access only	(a) 土地長遠用途(住宅(乙類))  (a) Long term use (Residential (Group B))

中西區區議會範圍內適合綠化或社區用途的臨時空置政府土地(截至2017年06月30日為止)

**Temporary Vacant Government Sites Available for Greening / Community Uses within Central and Western District Council Boundary (as at 30 June 2017)**

港島西及南區地政處 編號  District Lands Office/HKW&S Reference No.	位置  Location	面積(約) 平方米  Area (m <sup>2</sup> )	估計可使用時期  Estimated Available Period	土地狀況  Site Conditions	備註  Remarks
DLOHKW&S030	山頂鄰近加列山道61號的政府土地  Government land near No. 61 Mount Kellett Road, Peak	236.00	約2至3年  about 2 to 3 years	(a) 平地 / 傾斜 (b) 沒有路到除了經鄰近的建築物  (a) Flat/ Sloping (b) No direct access except through adjoining building	(a) 土地長遠用途(綠化地帶)  (a) Long term use (Green Belt)
DLOHKW&S035	堅尼地城近域多利道404號的政府土地  Government land near No. 404 Victoria Road, Kennedy Town	63.00	約2至3年  about 2 to 3 years	(a) 傾斜 / 起伏 (b) 只供行人出入  (a) Sloping/ Undulating (b) pedestrian access only	(a) 土地長遠用途(綠化地帶)  (a) Long term use (Green Belt)
DLOHKW&S038	堅尼地城摩星嶺道鄰近昭遠墳場的政府土地  Government land adjoining Chiu Yuen Cemetery, Mount Davis Road, Kennedy Town	1,820.00	約2至3年  about 2 to 3 years	(a) 傾斜 (b) 只供行人出入 (c) 稠密的樹木  (a) Sloping (b) pedestrian access only (c) dense vegetation	(a) 土地長遠用途(政府、機構或社區及綠化地帶)  (a) Long term use (Government, institution or community and Green Belt)

中西區區議會範圍內適合綠化或社區用途的臨時空置政府土地(截至2017年06月30日為止)

**Temporary Vacant Government Sites Available for Greening / Community Uses within Central and Western District Council Boundary (as at 30 June 2017)**

港島西及南區地政處 編號  District Lands Office/HKW&S Reference No.	位置  Location	面積(約) 平方米  Area (m <sup>2</sup> )	估計可使用時期  Estimated Available Period	土地狀況  Site Conditions	備註  Remarks
DLOHKW&S039	堅尼地城近堅尼地城 警察宿舍的政府土地  Government land near Police Quarters Kennedy Town, Kennedy Town	44.00	約2至3年  about 2 to 3 years	(a) 平地 (b) 只供行人出入  (a) Flat (b) pedestrian access only	(a) 土地長遠用途(綠化地帶)  (a) Long term use (Green Belt)
DLOHKW&S044	上環堅道與西摩道(堅 道花園後面)的政府土 地)  Government land behind Caine Road Garden at Caine Road & Seymour Road, Sheung Wan	256.00	約2至3年  about 2 to 3 years	(a) 平地 (b) 只供行人出入  (a) Flat (b) pedestrian access only	(a) 土地長遠用途(政府、機構或社區)  (a) Long term use (Government, institution or community)

中西區區議會範圍內適合綠化或社區用途的臨時空置政府土地(截至2017年06月30日為止)

**Temporary Vacant Government Sites Available for Greening / Community Uses within Central and Western District Council Boundary (as at 30 June 2017)**

港島西及南區地政處 編號  District Lands Office/HKW&S Reference No.	位置  Location	面積(約) 平方米  Area (m <sup>2</sup> )	估計可使用時期  Estimated Available Period	土地狀況  Site Conditions	備註  Remarks
DLOHKW&S045	上環西消防街的政府 土地  Government land at Western Fire Services Street, Sheung Wan	7.90	約2至3年  about 2 to 3 years	(a) 平地 (b) 只供行人出入  (a) Flat (b) pedestrian access only	(a) 土地長遠用途(休憩用地)  (a) Long term use (Open Space)
DLOHKW&S047	西營盤甘雨街的政府 土地  Government land at Kom U Street, Sai Ying Pun	37.00	約2至3年  about 2 to 3 years	(a) 平地 (b) 只供行人出入  (a) Flat (b) pedestrian access only	(a) 土地長遠用途(行人專用區/街道)  (a) Long term use (Pedestrian Precinct / Street)

中西區區議會範圍內適合綠化或社區用途的臨時空置政府土地(截至2017年06月30日為止)

**Temporary Vacant Government Sites Available for Greening / Community Uses within Central and Western District Council Boundary (as at 30 June 2017)**

港島西及南區地政處 編號  District Lands Office/HKW&S Reference No.	位置  Location	面積(約) 平方米  Area (m <sup>2</sup> )	估計可使用時期  Estimated Available Period	土地狀況  Site Conditions	備註  Remarks
DLOHKW&S097	堅尼地城鄰近香港域多利道47號的政府土地  Government land adjoining to No. 47 Victoria Road, Kennedy Town	27.00	約2至3年  about 2 to 3 years	(a) 平地 (b) 只供行人出入  (a) Flat (b) pedestrian access only	(a) 土地長遠用途(政府、機構或社區)  (a) Long term use (Government, institution or community)
DLOHKW&S117	山頂鄰近麥當奴道64號的政府土地  Government land adjacent to No. 64 MacDonnell Road, Peak	22.00	約2至3年  about 2 to 3 years	(a) 傾斜 (b) 只供行人出入  (a) sloping (b) pedestrian access only	(a) 土地長遠用途(住宅(丙類))  (a) Long term use (Residential (Group C))

中西區區議會範圍內適合綠化或社區用途的臨時空置政府土地(截至2017年06月30日為止)

**Temporary Vacant Government Sites Available for Greening / Community Uses within Central and Western District Council Boundary (as at 30 June 2017)**

港島西及南區地政處 編號  District Lands Office/HKW&S Reference No.	位置  Location	面積(約) 平方米  Area (m <sup>2</sup> )	估計可使用時期  Estimated Available Period	土地狀況  Site Conditions	備註  Remarks
DLOHKW&S129	上環發興街的政府土地  Government land at Fat Hing Street, Sheung Wan	29.00	約2至3年  about 2 to 3 years	(a) 傾斜 (b) 只供行人出入  (a) sloping (b) pedestrian access only	(a) 土地長遠用途(住宅(甲類))  (a) Long term use (Residential (Group A))
DLOHKW&S140	上環水坑口街9號橫巷的政府土地  Government land at side lane of No. 9 Possession Street, Sheung Wan	14.00	約2至3年  about 2 to 3 years	(a) 平地 (b) 只供行人出入  (a) Flat (b) pedestrian access only	(a) 土地長遠用途(住宅(甲類))  (a) Long term use (Residential (Group A))

中西區區議會範圍內適合綠化或社區用途的臨時空置政府土地(截至2017年06月30日為止)

**Temporary Vacant Government Sites Available for Greening / Community Uses within Central and Western District Council Boundary (as at 30 June 2017)**

港島西及南區地政處 編號  District Lands Office/HKW&S Reference No.	位置  Location	面積(約) 平方米  Area (m <sup>2</sup> )	估計可使用時期  Estimated Available Period	土地狀況  Site Conditions	備註  Remarks
DLOHKW&S0172	山頂羅便臣道99C號對 面的政府土地  Government land outside No. 99C Robinson Road, Peak	38.00	約2至3年  about 2 to 3 years	(a) 平地 (b) 只供行人出入  (a) Flat (b) pedestrian access only	(a) 土地長遠用途(住宅(乙類))  (a) Long term use (Residential (Group B))
DLOHKW&S185	堅尼地城摩星嶺道鄰 近昭遠墳場的政府土 地  Government Land at Mount Davis Road near Chiu Yuen Cemetery, Kennedy Town	313.00	約2至3年  about 2 to 3 years	(a) 傾斜 (b) 可供車輛出入  (a) sloping (b) with vehicular access	(a) 土地長遠用途(政府、機構或社區)  (a) Long term use (Government, institution or community)

註：

有關個別用地的詳情，請致電(2835 1701)港島西及南區地政處查詢

Notes :

For enquiry, please call District Lands Office/Hong Kong West & South (Tel. no. 2835 1701).

As the availability of each site is subject to changes, any interested party should approach District Lands office/Hong Kong West and South for up-to-date information before application.

SITE REFERENCE No. DLOHKW&S005

山頂白加道前食物環境衛生署公廁  
FORMER FEHD TOILET SITE AT BARKER ROAD, PEAK

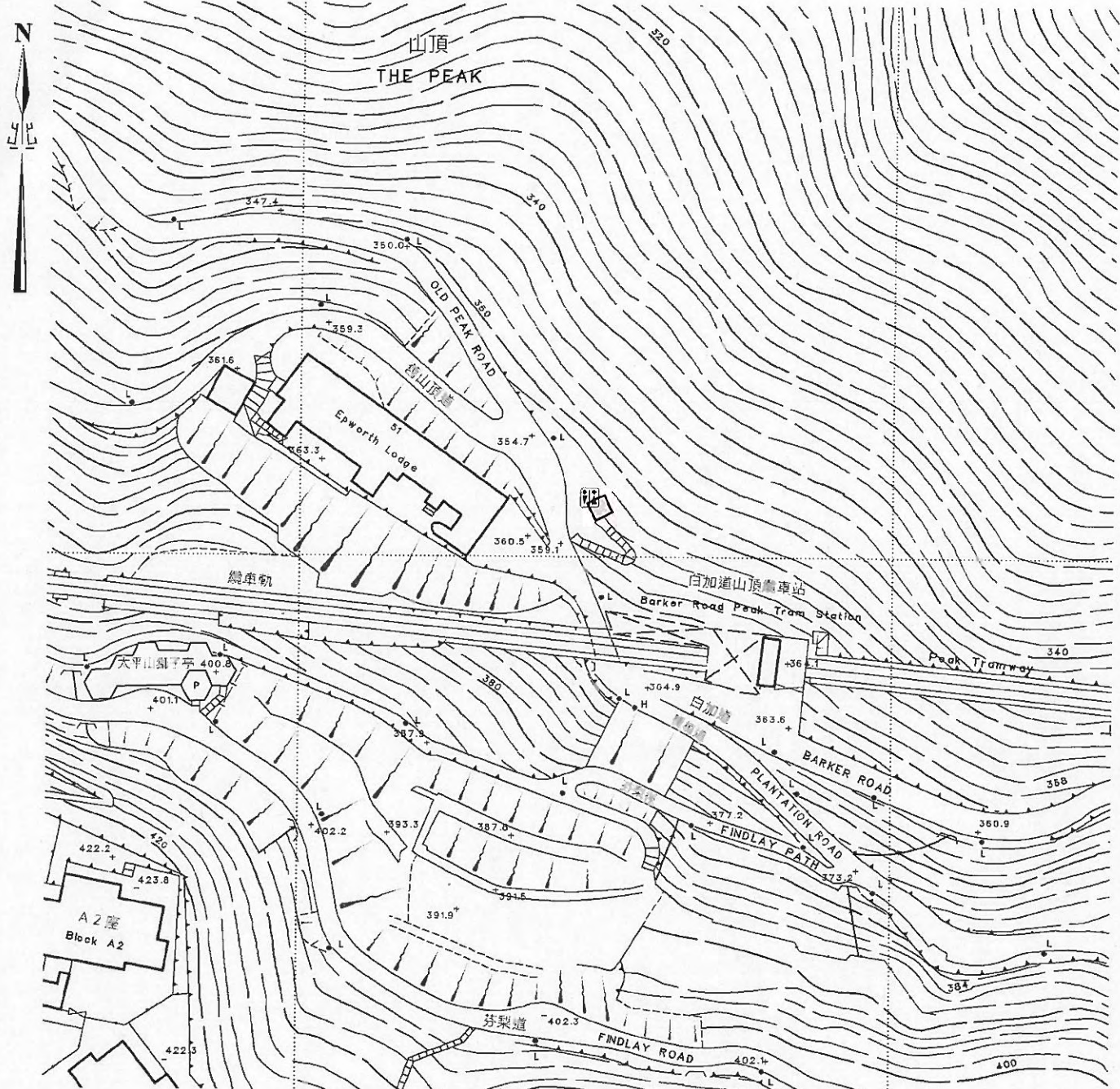

以粉紅色標示的面積約為9.4平方米  
COLOURED PINK AREA 9.4 SQUARE METRES (ABOUT)

比例尺 SCALE 1:1 000

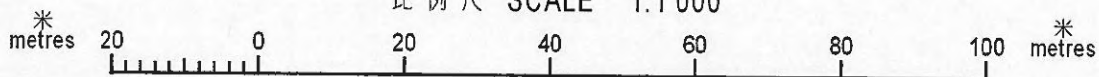

只作識別用 FOR IDENTIFICATION PURPOSES ONLY

地政總署 港島西及南區地政處  
District Lands Office, Hong Kong West and South  
Lands Department

圖則由港島測量處繪製  
Plan Prepared by District Survey Office, Hong Kong

© 香港特別行政區政府 一 版權所有 Copyright reserved - Hong Kong SAR Government

檔案編號 File No. DLO/HKW&S L/M 1063/SHMS/82

測量圖編號 Survey Sheet No. 11-SW-13C

發展藍圖編號 Layout Plan No.

參考圖編號 Reference Plan No.

圖則編號 PLAN No. HKM9502-74

日期 Date: 27/03/2013



SITE REFERENCE No. DLOHKW&S013

上環城皇街  
AT SHING WONG STREET, SHEUNG WAN



以粉紅色標示的面積約為 44 平方米  
COLOURED PINK AREA 44 SQUARE METRES (ABOUT)

比例尺 SCALE 1:1 000

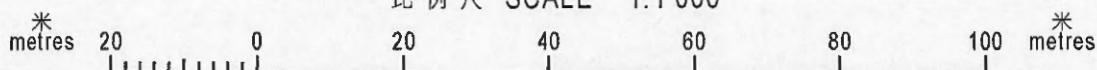

只作識別用 FOR IDENTIFICATION PURPOSES ONLY

地政總署 港島西及南區地政處  
District Lands Office, Hong Kong West and South  
Lands Department

圖則由港島測量處繪製  
Plan Prepared by District Survey Office, Hong Kong

© 香港特別行政區政府 一版權所有 Copyright reserved - Hong Kong SAR Government

檔案編號 File No. DLO/HKW&S L/M 1063/SHMS/82

測量圖編號 Survey Sheet No. 11-SW-8C

發展藍圖編號 Layout Plan No.

參考圖編號 Reference Plan No.

圖則編號 PLAN No. HKM9502-73

日期 Date: 27/03/2013

SITE REFERENCE No. DLOHKW&S024

山頂干德道24號前面

FRONTING No. 24 CONDUIT ROAD, PEAK

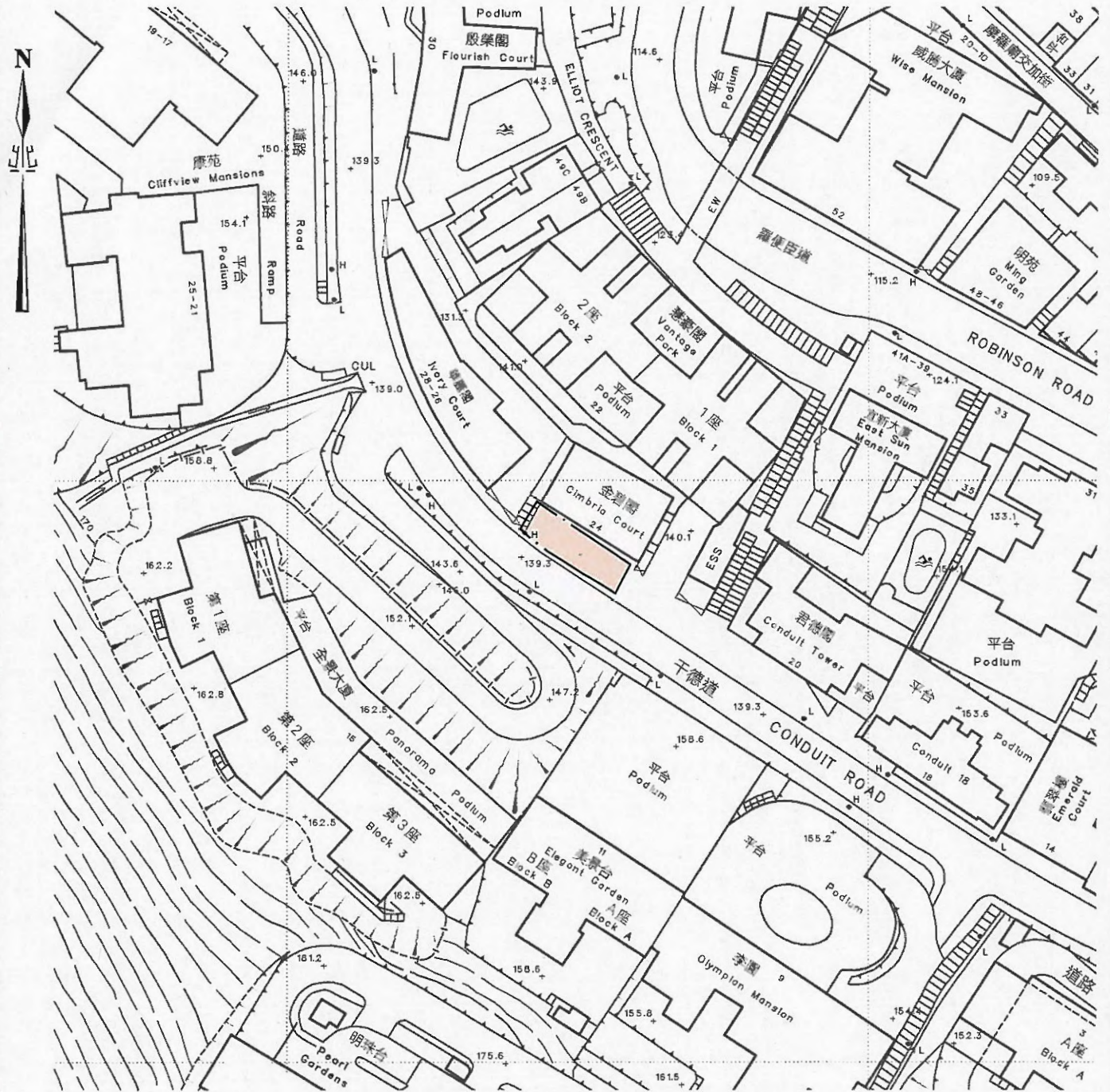

以粉紅色標示的面積約為 114 平方米  
COLOURED PINK AREA 114 SQUARE METRES (ABOUT)

比例尺 SCALE 1:1 000

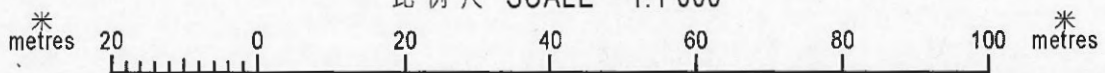

只作識別用 FOR IDENTIFICATION PURPOSES ONLY

地政總署 港島西及南區地政處  
District Lands Office, Hong Kong West and South  
Lands Department

圖則由港島測量處繪製  
Plan Prepared by District Survey Office, Hong Kong

© 香港特別行政區政府 版權所有 Copyright reserved - Hong Kong SAR Government

檔案編號 File No. DLO/HKW&S L/M 1063/SHMS/82

測量圖編號 Survey Sheet No. 11-SW-13A

發展藍圖編號 Layout Plan No.

參考圖編號 Reference Plan No.

圖則編號 PLAN No. HKM9502-69a

日期 Date: 22/04/2013

SITE REFERENCE No. DLOHKW&S030

山頂鄰近加列山道61號

NEAR No. 61 MOUNT KELLETT ROAD, PEAK

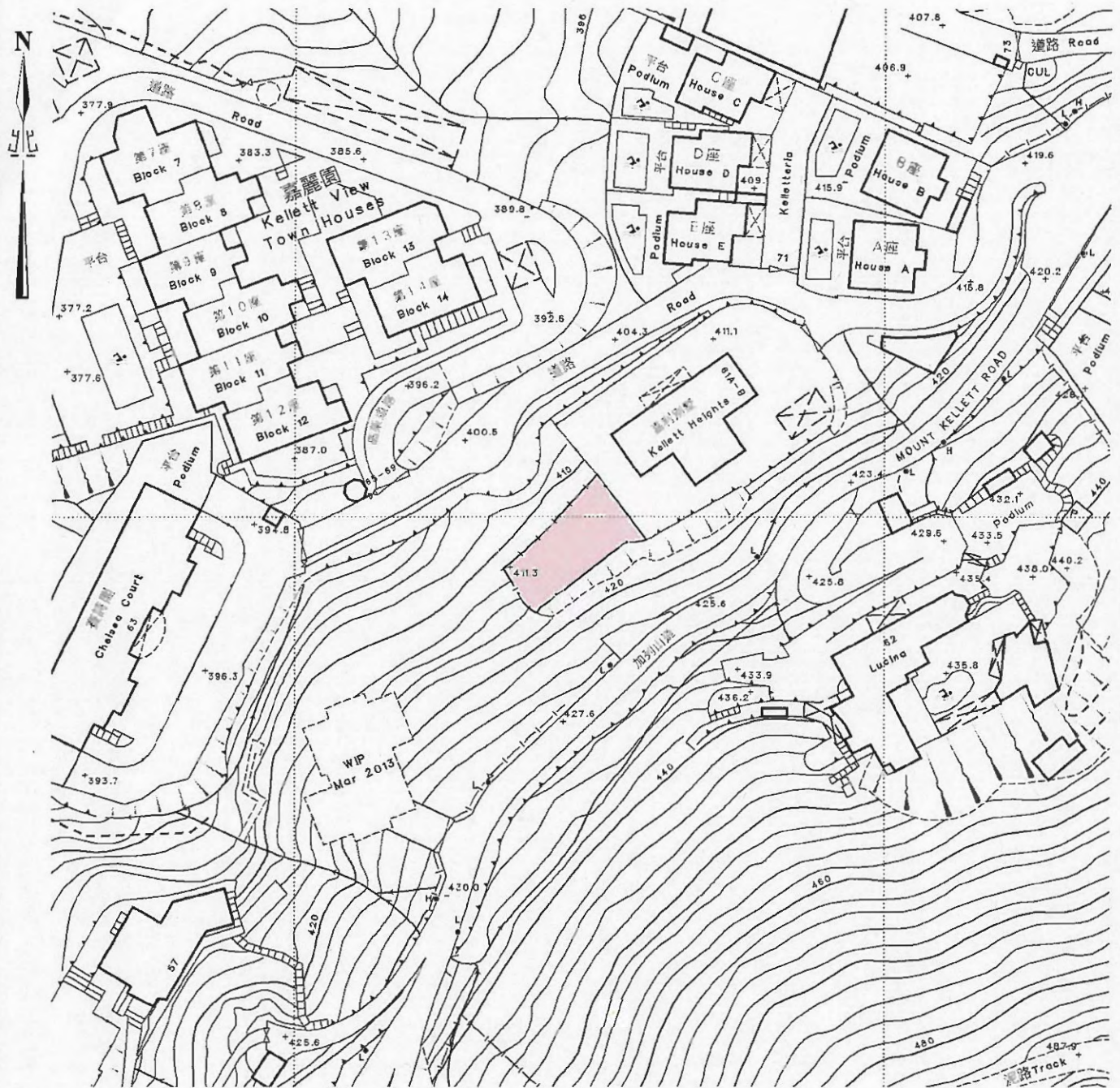

以粉紅色標示的面積約為236平方米

COLOURED PINK AREA 236 SQUARE METRES (ABOUT)

比例尺 SCALE 1:1 000

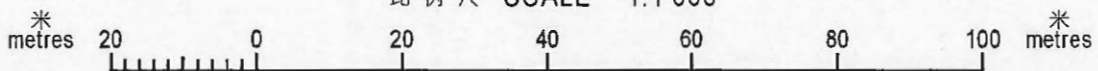

只作識別用 FOR IDENTIFICATION PURPOSES ONLY

地政總署 港島西及南區地政處  
District Lands Office, Hong Kong West and South Lands Department

圖則由港島測量處繪製  
Plan Prepared by District Survey Office, Hong Kong

© 香港特区政府 版權所有 Copyright reserved - Hong Kong SAR Government

檔案編號 File No. DLO/HKW&S L/M 1063/SHMS/82

測量圖編號 Survey Sheet No. 11-SW-18A & 18C

發展藍圖編號 Layout Plan No.

參考圖編號 Reference Plan No.

圖則編號 PLAN No. HKM9502-68

日期 Date: 24/03/2013

SITE REFERENCE No. DLOHKW&S035

堅尼地城近域多利道404號

NEAR No. 404 VICTORIA ROAD, KENNEDY TOWN



以粉紅色標示的面積約為 63 平方米  
COLOURED PINK AREA 63 SQUARE METRES (ABOUT)

比例尺 SCALE 1:1 000

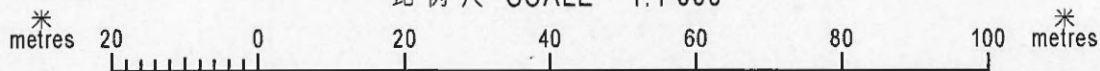

只作識別用 FOR IDENTIFICATION PURPOSES ONLY

地政總署 港島西及南區地政處  
District Lands Office, Hong Kong West and South  
Lands Department

圖則由港島測量處繪製  
Plan Prepared by District Survey Office, Hong Kong

© 香港特別行政區政府 一 版權所有 Copyright reserved - Hong Kong SAR Government

檔案編號 File No. DLO/HKW&S L/M 1063/SHMS/82

測量圖編號 Survey Sheet No. 11-SW-6C

發展藍圖編號 Layout Plan No.

參考圖編號 Reference Plan No.

圖則編號 PLAN No. HKM9502-67

日期 Date : 24/03/2013

SITE REFERENCE No. DLOHKW&S038

堅尼地城摩星嶺道鄰近昭遠墳場

ADJOINING CHIU YUEN CEMETERY, MOUNT DAVIS ROAD, KENNEDY TOWN

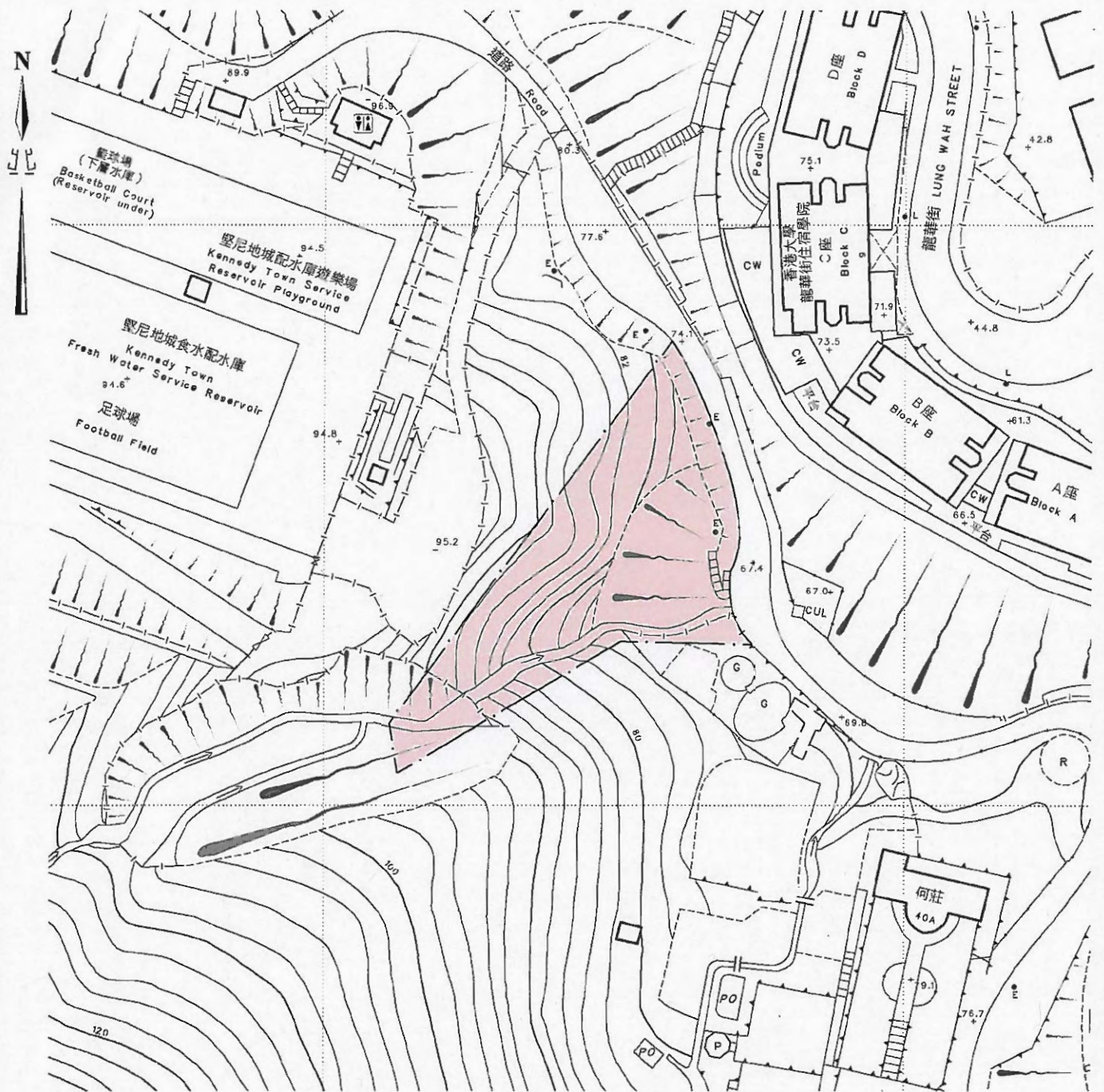

以粉紅色標示的面積約為 1 820 平方米  
COLOURED PINK AREA 1 820 SQUARE METRES (ABOUT)

比例尺 SCALE 1:1 000

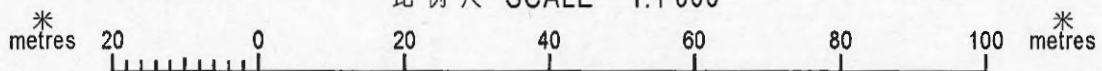

只作識別用 FOR IDENTIFICATION PURPOSES ONLY

地政總署 港島西及南區地政處  
District Lands Office, Hong Kong West and South  
Lands Department

圖則由港島測量處繪製  
Plan Prepared by District Survey Office, Hong Kong

© 香港特別行政區政府 版權所有 Copyright reserved - Hong Kong SAR Government

檔案編號 File No. DLO/HKW&S L/M 1063/SHMS/82

測量圖編號 Survey Sheet No. 11-SW-11B

發展藍圖編號 Layout Plan No.

參考圖編號 Reference Plan No.

圖則編號 PLAN No. HKM9502-1

日期 Date: 01/02/2013

SITE REFERENCE No. DLOHKW&S039

堅尼地城近堅尼地城警察宿舍  
NEAR POLICE QUARTERS KENNEDY TOWN, KENNEDY TOWN

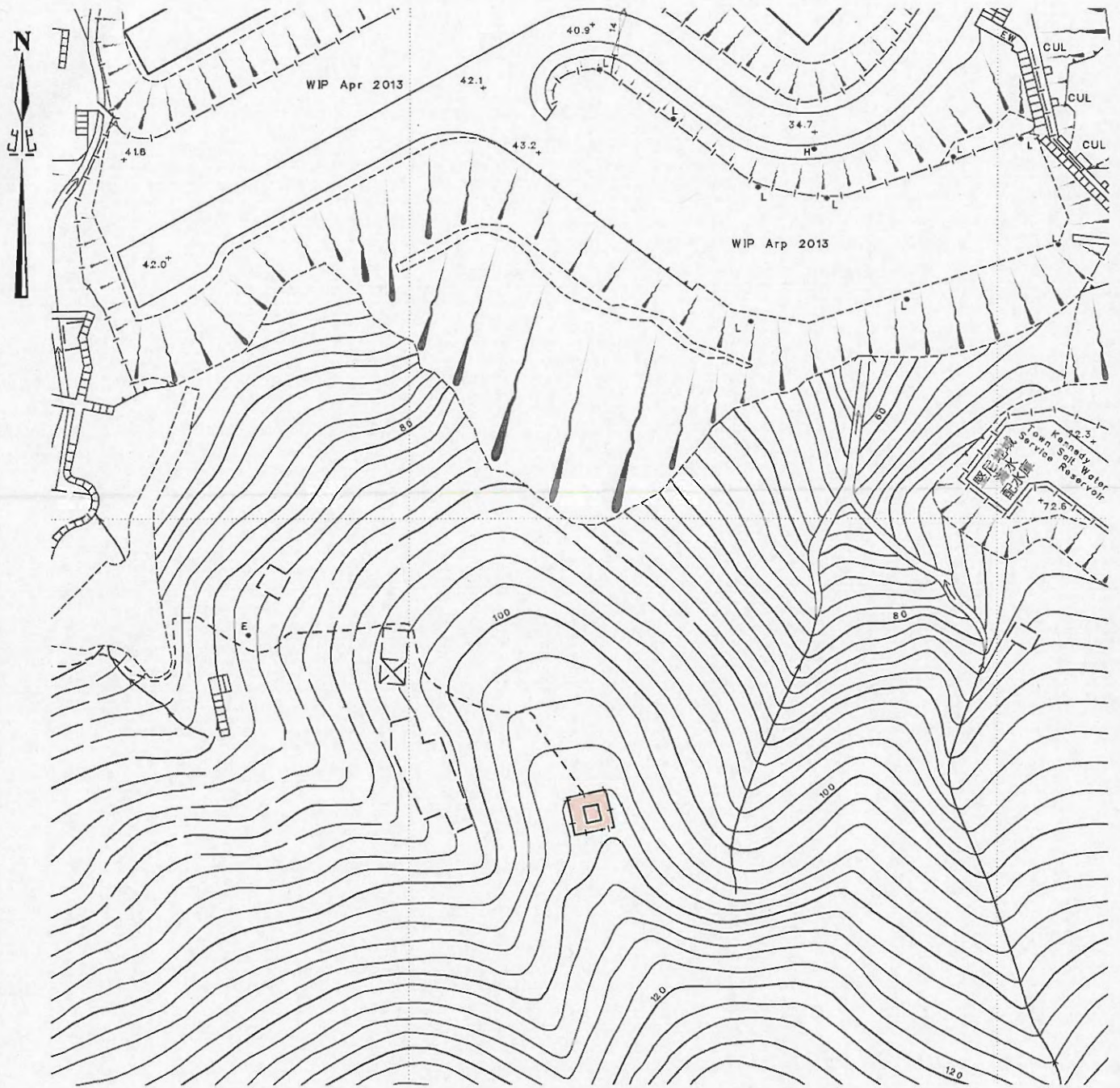

以粉紅色標示的面積約為44平方米  
COLOURED PINK AREA 44 SQUARE METRES (ABOUT)

比例尺 SCALE 1:1 000

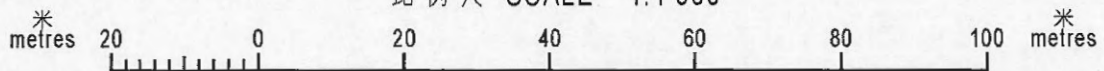

只作識別用 FOR IDENTIFICATION PURPOSES ONLY

地政總署 港島西及南區地政處  
District Lands Office, Hong Kong West and South  
Lands Department

圖則由港島測量處繪製  
Plan Prepared by District Survey Office, Hong Kong

© 香港特別行政區政府 版權所有 Copyright reserved - Hong Kong SAR Government

檔案編號 File No. DLO/HKW&S L/M 1063/SHMS/82

測量圖編號 Survey Sheet No. 11-SW-6C

發展藍圖編號 Layout Plan No.

參考圖編號 Reference Plan No.

圖則編號 PLAN No. HKM9502-2a

日期 Date: 22/04/2013

SITE REFERENCE No. DLOHKW&S044

上環堅道與西摩道(堅道花園的後面)  
BEHIND CAINE ROAD GARDEN AT  
CAINE ROAD & SEYMOUR ROAD, SHEUNG WAN

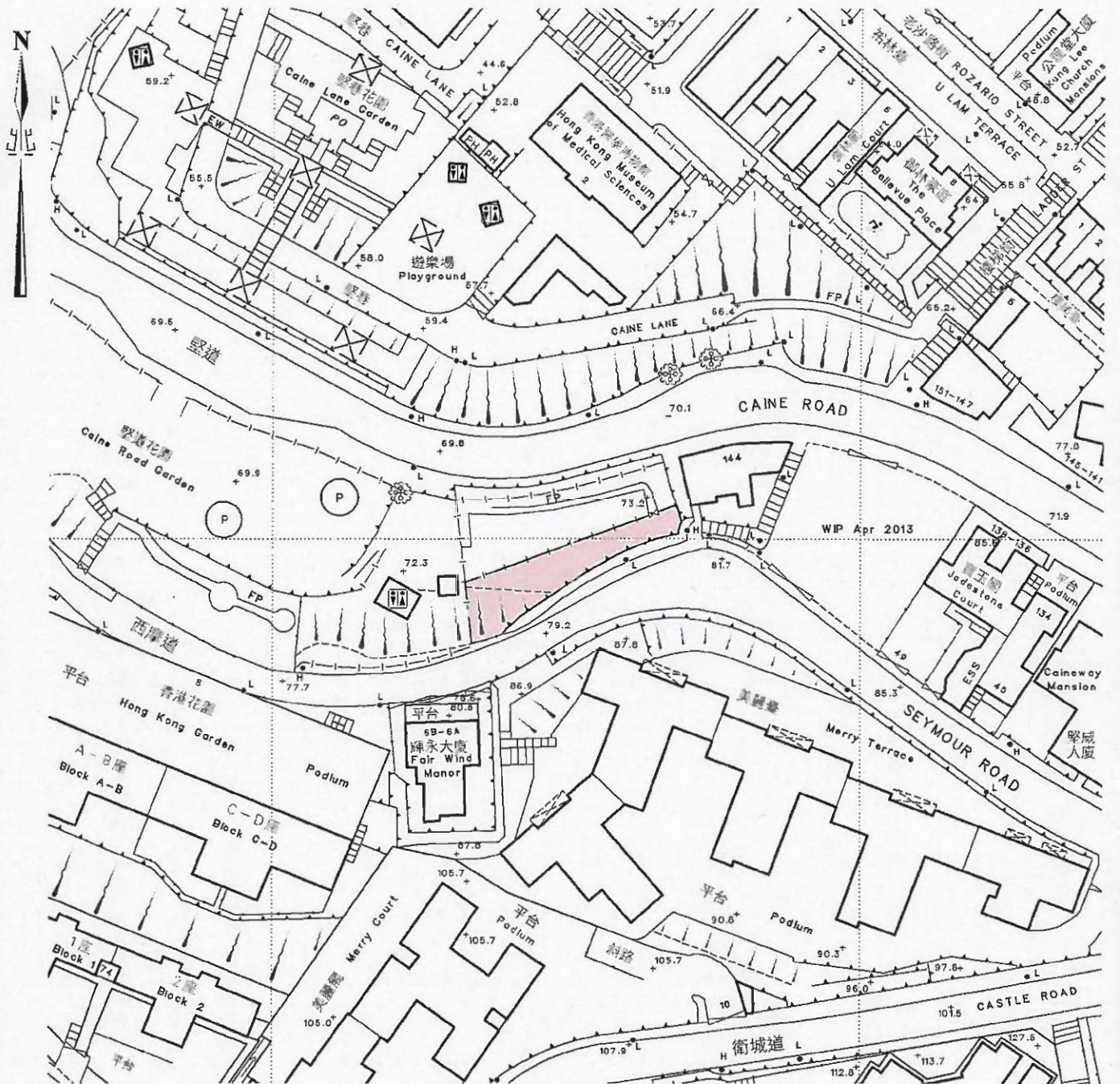

以粉紅色標示的面積約為 256 平方米  
COLOURED PINK AREA 256 SQUARE METRES (ABOUT)

比例尺 SCALE 1:1 000

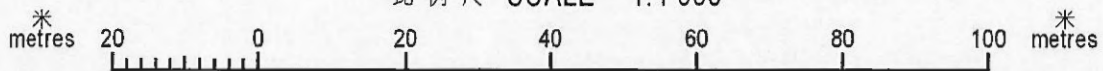

只作識別用 FOR IDENTIFICATION PURPOSES ONLY

地政總署 港島西及南區地政處  
District Lands Office, Hong Kong West and South  
Lands Department

圖則由港島測量處繪製  
Plan Prepared by District Survey Office, Hong Kong

© 香港特別行政區政府 版權所有 Copyright reserved - Hong Kong SAR Government

檔案編號 File No. DLO/HKW&S L/M 1063/SHMS/82

測量圖編號 Survey Sheet No. 11-SW-8C

發展藍圖編號 Layout Plan No.

參考圖編號 Reference Plan No.

圖則編號 PLAN No. HKM9502-4a

日期 Date: 22/04/2013

SITE REFERENCE No. DLOHKW&S045

上環西消防街  
AT WESTERN FIRE SERVICES STREET, SHEUNG WAN

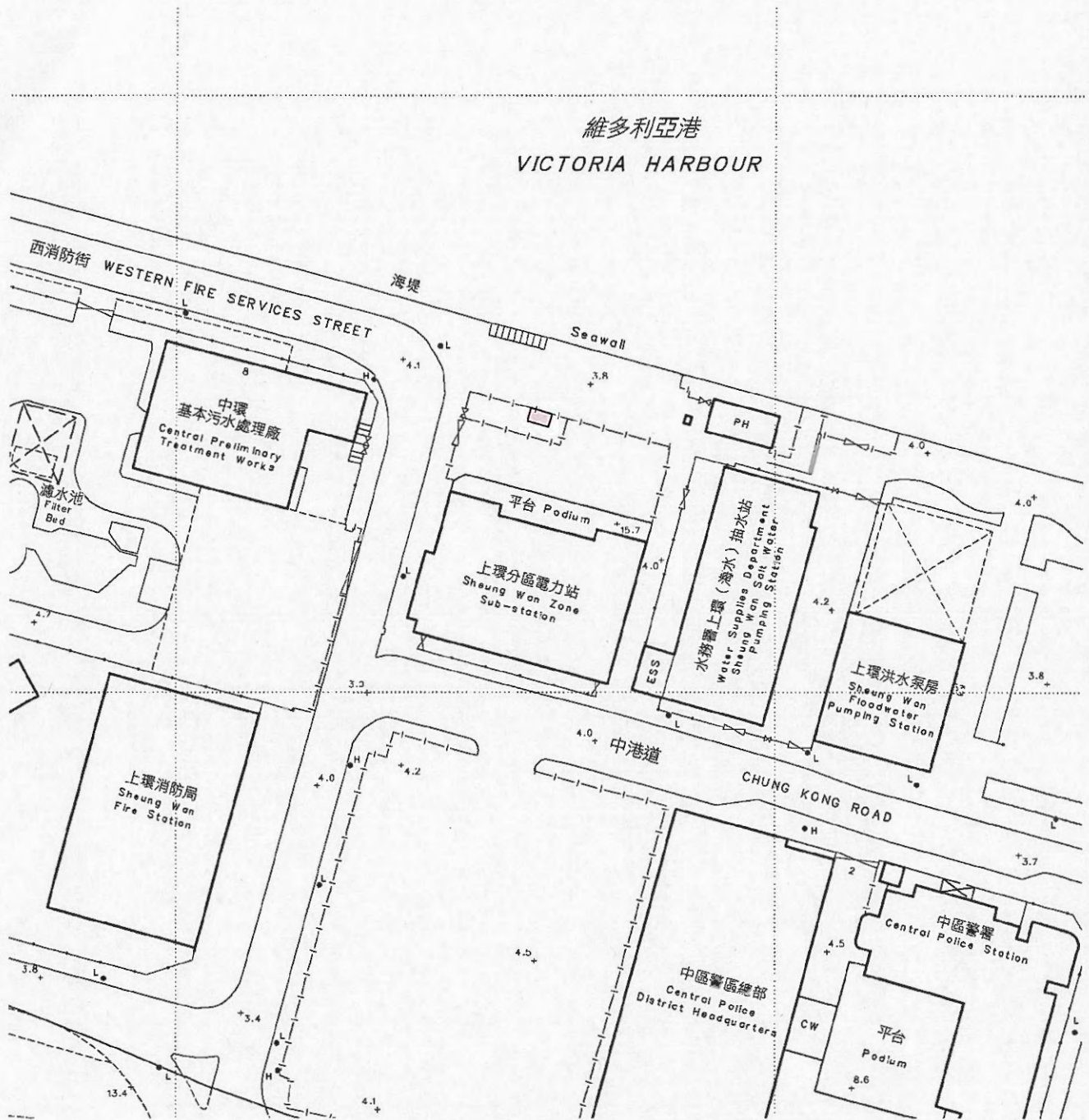

以粉紅色標示的面積約為 7.9 平方米  
COLOURED PINK AREA 7.9 SQUARE METRES (ABOUT)

比例尺 SCALE 1:1 000

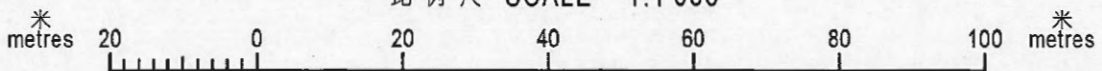

只作識別用 FOR IDENTIFICATION PURPOSES ONLY



地政總署 港島西及南區地政處  
District Lands Office, Hong Kong West and South  
Lands Department

圖則由港島測量處繪製  
Plan Prepared by District Survey Office, Hong Kong

© 香港特別行政區政府 版權所有 Copyright reserved - Hong Kong SAR Government

檔案編號 File No. DLO/HKW&S L/M 1063/SHMS/82

測量圖編號 Survey Sheet No. 11-SW-8A

發展藍圖編號 Layout Plan No.

參考圖編號 Reference Plan No.

圖則編號 PLAN No. HKM9502-5

日期 Date : 05/02/2013



SITE REFERENCE No. DLOHKW&S047

西營盤甘雨街  
AT KOM U STREET, SAI YING PUN



以粉紅色標示的面積約為37平方米  
COLOURED PINK AREA 37 SQUARE METRES (ABOUT)

比例尺 SCALE 1:1 000

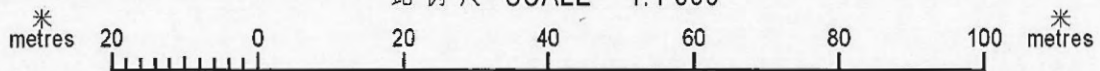

只作識別用 FOR IDENTIFICATION PURPOSES ONLY

地政總署 港島西及南區地政處  
District Lands Office, Hong Kong West and South  
Lands Department

圖則由港島測量處繪製  
Plan Prepared by District Survey Office, Hong Kong

© 香港特別行政區政府 - 版權所有 Copyright reserved - Hong Kong SAR Government

檔案編號 File No. DLO/HKW&S L/M 1063/SHMS/82

測量圖編號 Survey Sheet No. 11-SW-8A

發展藍圖編號 Layout Plan No.

參考圖編號 Reference Plan No.

圖則編號 PLAN No. HKM9502-6

日期 Date: 05/02/2013

SITE REFERENCE No. DLOHKW&S097

堅尼地城鄰近域多利道47號

ADJOINING TO No. 47 VICTORIA ROAD, KENNEDY TOWN



以粉紅色標示的面積約為 27 平方米

COLOURED PINK AREA 27 SQUARE METRES (ABOUT)

比例尺 SCALE 1:1 000

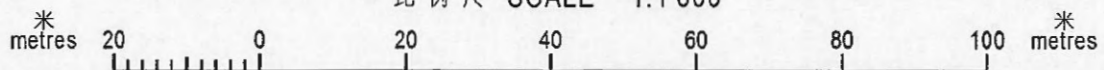

只作識別用 FOR IDENTIFICATION PURPOSES ONLY

地政總署 港島西及南區地政處  
District Lands Office, Hong Kong West and South  
Lands Department

圖則由港島測量處繪製  
Plan Prepared by District Survey Office, Hong Kong

© 香港特別行政區政府 一 版權所有 Copyright reserved - Hong Kong SAR Government

檔案編號 File No. DLO/HKW&S L/M 1063/SHMS/82

測量圖編號 Survey Sheet No. 11-SW-6D

發展藍圖編號 Layout Plan No.

參考圖編號 Reference Plan No.

圖則編號 PLAN No. HKM9502-33

日期 Date : 28/02/2013

SITE REFERENCE No. DLOHKW&S117

山頂鄰近麥當奴道64號

ADJACENT TO No. 64 MACDONNELL ROAD, PEAK

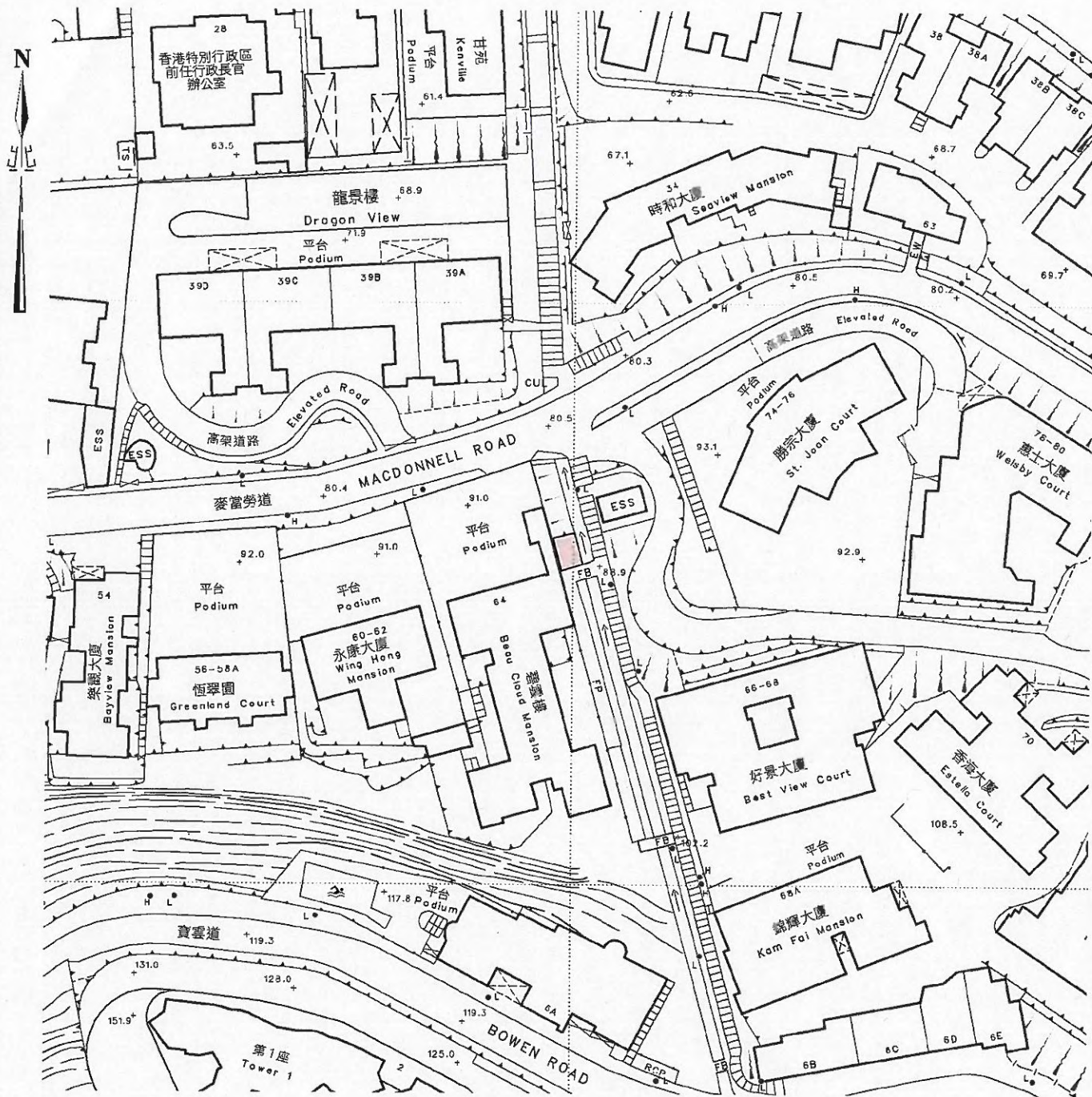

以粉紅色標示的面積約為 22 平方米  
COLOURED PINK AREA 22 SQUARE METRES (ABOUT)

比例尺 SCALE 1:1 000

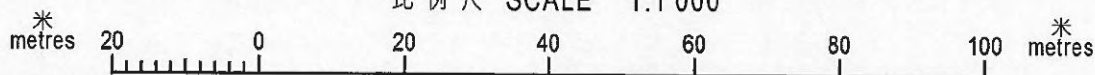

只作識別用 FOR IDENTIFICATION PURPOSES ONLY

地政總署 港島西及南區地政處  
District Lands Office, Hong Kong West and South  
Lands Department

圖則由港島測量處繪製  
Plan Prepared by District Survey Office, Hong Kong

© 香港特別行政區政府 版權所有 Copyright reserved - Hong Kong SAR Government

檔案編號 File No. DLO/HKW&S L/M 1063/SHMS/82

測量圖編號 Survey Sheet No. 11-SW-13B & 14A

發展藍圖編號 Layout Plan No.

參考圖編號 Reference Plan No.

圖則編號 PLAN No. HKM9502-41

日期 Date : 06/03/2013

SITE REFERENCE No. DLOHKW&S129

上環發興街  
AT FAT HING STREET, SHEUNG WAN

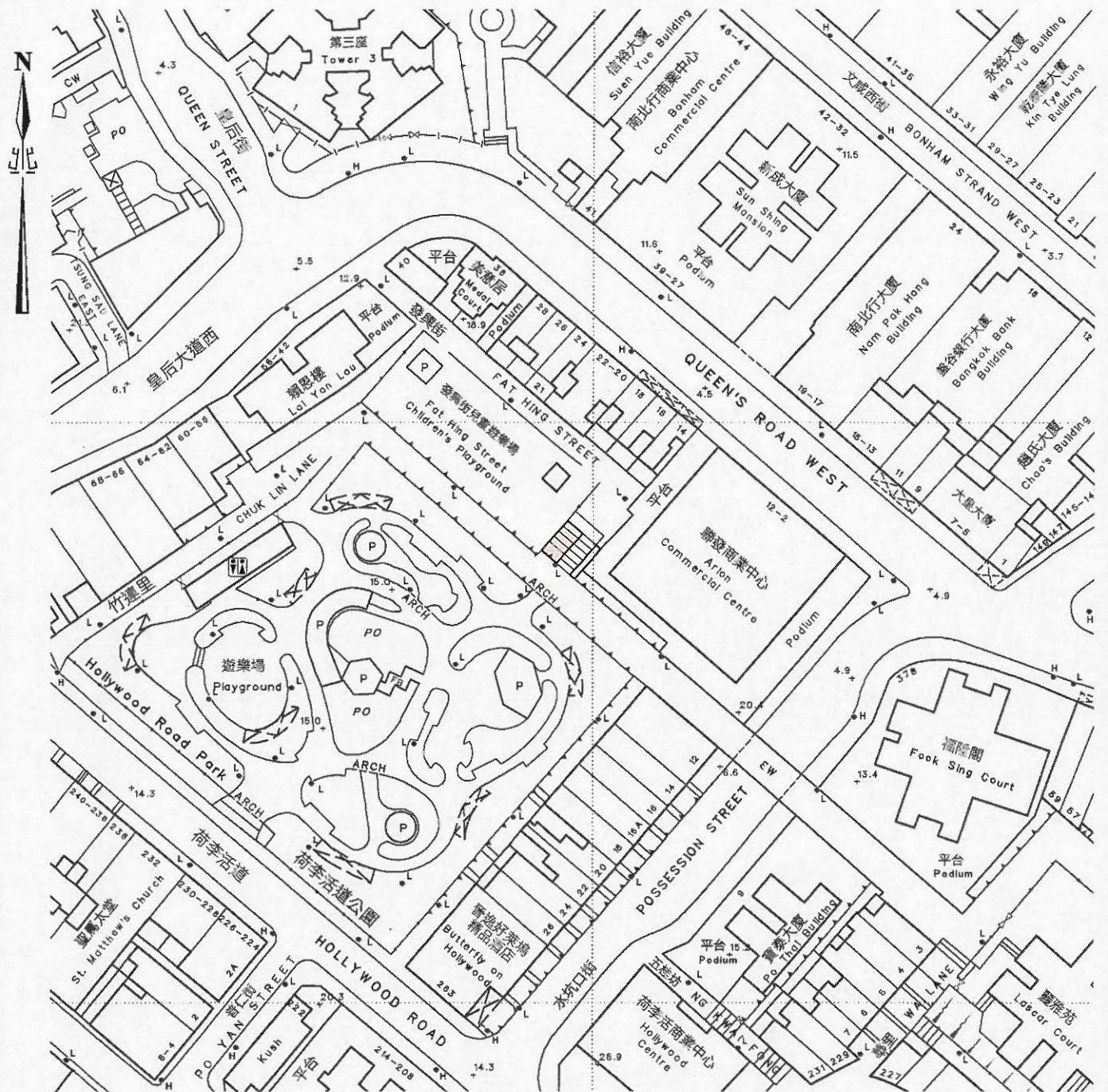

以粉紅色標示的面積約為 29 平方米  
COLOURED PINK AREA 29 SQUARE METRES (ABOUT)

比例尺 SCALE 1:1 000

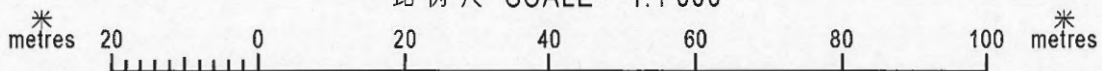

只作識別用 FOR IDENTIFICATION PURPOSES ONLY

地政總署 港島西及南區地政處  
District Lands Office, Hong Kong West and South  
Lands Department

圖則由港島測量處繪製

Plan Prepared by District Survey Office, Hong Kong

© 香港特別行政區政府 一 版權所有 Copyright reserved - Hong Kong SAR Government

檔案編號 File No. DLO/HKW&S L/M 1063/SHMS/82

測量圖編號 Survey Sheet No. 11-SW-8A

發展藍圖編號 Layout Plan No.

參考圖編號 Reference Plan No.

圖則編號 PLAN No. HKM9502-45

日期 Date: 11/03/2013

SITE REFERENCE No. DLOHKW&S140

上環水坑口街9號橫巷

AT SIDE LANE OF No. 9 POSSESSION STREET, SHEUNG WAN

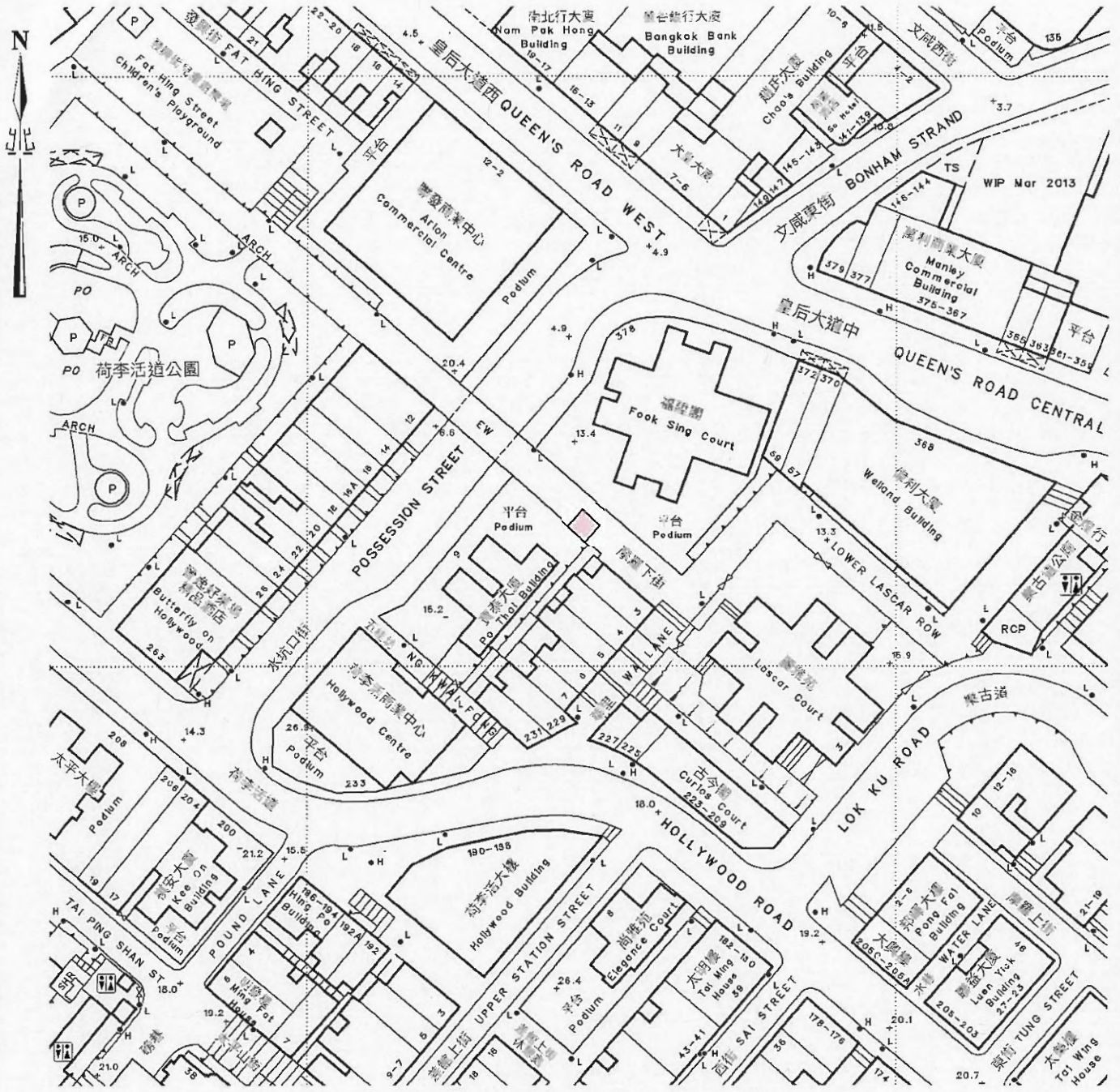

以粉紅色標示的面積約為14平方米  
COLOURED PINK AREA 14 SQUARE METRES (ABOUT)

比例尺 SCALE 1:1 000

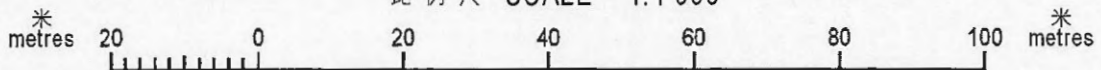

只作識別用 FOR IDENTIFICATION PURPOSES ONLY

地政總署 港島西及南區地政處  
District Lands Office, Hong Kong West and South  
Lands Department

圖則由港島測量處繪製  
Plan Prepared by District Survey Office, Hong Kong

© 香港特別行政區政府 版權所有 Copyright reserved - Hong Kong SAR Government

檔案編號 File No. DLO/HKW&S L/M 1063/SHMS/82

測量圖編號 Survey Sheet No. 11-SW-8A

發展藍圖編號 Layout Plan No.

參考圖編號 Reference Plan No.

圖則編號 PLAN No. HKM9502-52

日期 Date: 14/03/2013

SITE REFERENCE No. DLOHKW&S172

山頂羅便臣道99號對面

OUTSIDE No. 99C ROBINSON ROAD, PEAK



以粉紅色標示的面積約為 38 平方米  
COLOURED PINK AREA 38 SQUARE METRES (ABOUT)

比例尺 SCALE 1:1 000

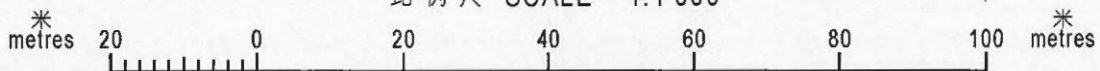

只作識別用 FOR IDENTIFICATION PURPOSES ONLY

地政總署 港島西及南區地政處  
District Lands Office, Hong Kong West and South Lands Department

圖則由港島測量處繪製  
Plan Prepared by District Survey Office, Hong Kong

© 香港特別行政區政府 一 版權所有 Copyright reserved - Hong Kong SAR Government

檔案編號 File No. DLO/HKW&S L/M 1063/SHMS/82

測量圖編號 Survey Sheet No. 11-SW-8C

發展藍圖編號 Layout Plan No.

參考圖編號 Reference Plan No.

圖則編號 PLAN No. HKM9502-61

日期 Date: 21/03/2013

SITE REFERENCE No. DLOHKW&S185

堅尼地城摩星嶺道近昭遠墳場

AT MOUNT DAVIS ROAD NEAR CHIU YUEN CEMETERY, KENNEDY TOWN



以粉紅色標示的面積約為 313 平方米  
COLOURED PINK AREA 313 SQUARE METRES (ABOUT)

比例尺 SCALE 1:1 000

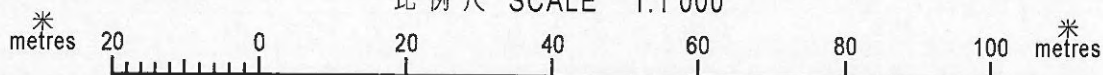

只作識別用 FOR IDENTIFICATION PURPOSES ONLY

地政總署 港島西及南區地政處  
District Lands Office, Hong Kong West and South  
Lands Department

圖則由港島測量處繪製

Plan Prepared by District Survey Office, Hong Kong

© 香港特別行政區政府 版權所有 Copyright reserved - Hong Kong SAR Government

檔案編號 File No. DLO/HKW&S L/M 1063/SHMS/82

測量圖編號 Survey Sheet No. 11-SW-11B

發展藍圖編號 Layout Plan No.

參考圖編號 Reference Plan No.

圖則編號 PLAN No. HKM9502-65

日期 Date: 23/03/2013