

**Short-Term Greening Proposal
at New Yau Ma Tei Typhoon Shelter North**

Purpose

The purpose of this paper is to consult Yau Tsim Mong District Council (hereafter “YTMDC”) with Draft Short-Term Greening Proposal at New Yau Ma Tei Typhoon Shelter North (hereafter “the Proposal”) and seek support from District Council Members.

Background

2. During the District Council (hereafter “DC”) meeting held in August 2006, YTMDC endorsed the Mong Kok and Yau Ma Tei Greening Master Plan (hereafter “the GMP”), which includes short, medium and long-term proposals. Short-term proposals are those greening measures conforming to the existing layout of the districts, and could make full use of the existing space for greening and can be implemented within one to two years.

3. Based on the short-term greening proposals under the GMP, we have identified additional opportunities to enhance the greening in Yau Tsim Mong District. As such, ACLA Limited, the landscape consultants of the GMP was appointed to prepare the greening design of the Proposal.

The Proposal

4. The landscape consultant of Civil Engineering Development Department (CEDD) has conducted an on-site survey and studied the site context with a view to thorough understanding of the existing condition, such as accessibility, greenery and public facilities of the study area.

5. In addition, the land use and developments in the vicinity of the study area are taken into account, for example, the Open Space at Ex-Tai Kok Tsui Bus Terminus, Hoi Fai Road, Tai Kok Tsui (Project Code: 428RO), located to the north of the study area is a planned Recreation, Culture and Amenities Project of ArchSD. According to the existing information, the project is scheduled to be commenced in 2011 for completion by 2013. This planned open space will reconcile the design elements in the Proposal in order to maximize the overall greening effect.

6. We have discussed with relevant government departments about the design concept of the Proposal in May 2009. The present draft Proposal has been revised and incorporated with departmental comments accordingly.

7. The Proposal includes a detailed landscape design that not only makes full use of greening opportunities, improving and adding street amenities, but also recommend suitable greening measures and planting species. **Appendix I** shows the plan and sections of the Proposal ; **Appendix II** exhibits design details and recommended planting species; **Appendix III** demonstrates the existing site conditions with photos.

8. We proposed to utilize part of the study area for pedestrian leisure walking and preserving valuable existing trees, such as *Acacia mangium*, as well as adding planting areas along sidewalk and planting a row of broadleaf trees to create shading. Flowering shrubs will be planted in the planting areas to beautify the surroundings. Indeed, the Proposal has made reference to a successful example of Central Ferry Pier.

9. While retrofitting public amenities, we have fully considered existing and future activities to ensure convenience and safety of end users. For instance, we would add railings and retain ship bollards to ensure safety of pedestrian. We also focused on the integration of greening with street furniture, such as using raised planters as resting seats for pedestrian.

10. For selection of plant species, we will refer to GMP recommended planting palette. Moreover, other important factors like site conditions, characteristics and functions of plants (wind tolerance or salt tolerance), soil and microclimate (including sunlight and wind), size of planting areas and visual effects will be considered during detailed design stage.

11. The greening target of the Proposal is to plant 70 trees and 4,500 shrubs. The estimated construction cost will be approximately HK\$ 2 million. It will be funded by the GMP project.

Future Works

12. CEDD will further study and follow-up the comments from DC Members on this paper or the Proposal. CEDD will also continue the consultation among relevant government departments in respect of the Proposal. The Proposal is expected to commence in the 3rd quarter of 2009 for completion by end 2009.

Consultation

13. If Members of the YTMDC support the Short-Term Greening Proposals at New Yau Ma Tei Typhoon Shelter North, CEDD will proceed with the implementation of the greening works as soon as possible.

Civil Engineering Development Department
June 2009

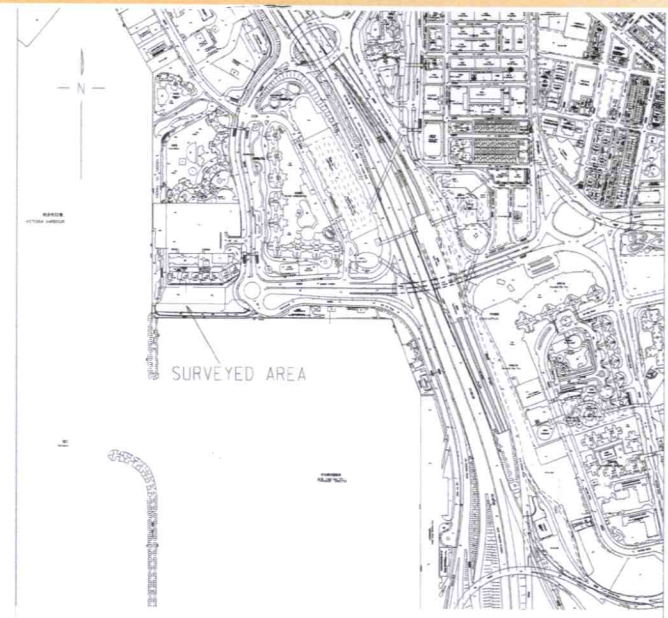
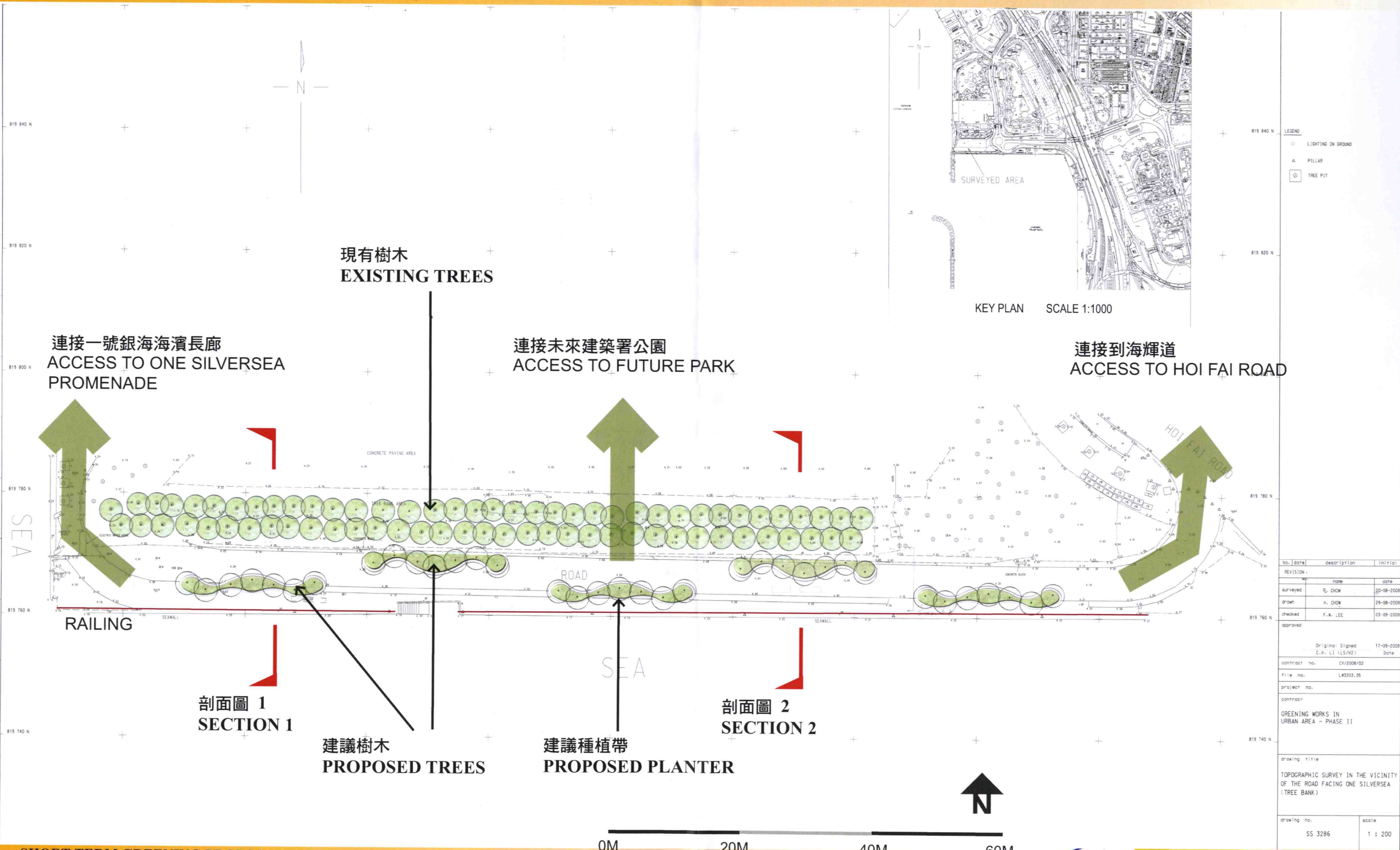

LEGEND

- LIGHTING ON GROUND
- △ PILLAR
- ⊗ TREE PIT

No.	Date	Description	Initial
REVISION			
		name	date
surveyed		T. CHOW	20-08-2008
drawn		H. CHOW	29-08-2008
checked		F.W. LEE	03-09-2008
approved			
		Original Signed	17-09-2008
		C.H. LI (LS/R2)	Date
contract no.	CI/2008/02		
file no.	LW3203.05		
project no.			
contract			
GREENING WORKS IN URBAN AREA - PHASE II			

drawing title
 TOPOGRAPHIC SURVEY IN THE VICINITY OF THE ROAD FACING ONE SILVERSEA (TREE BANK)

drawing no.	scale
SS 3286	1 : 200





REFERENCE IMAGE 參考圖片
NEW FERRY PIERS PROMENADE 新碼頭海濱行人路
CENTRAL RECLAMATION PHASE ONE 中環填海工程第一期

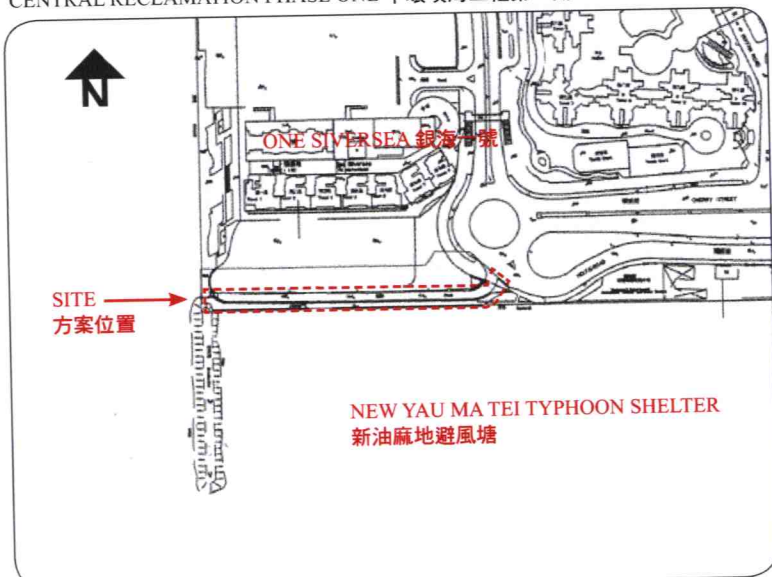

DRAFT PROPOSAL 建議方案

- NEW TREE AND SHRUB PLANTER WITH SEATWALLS
- WALKWAY
- SHELTERED BOULEVARD WITH FOOTPATH LINKS TO NEW PARK
- CHAINLINK FENCE RELOCATED
- EXISTING TREES RETAINED
- FOOTPATH REPLACED WITH FLOWERING SHRUBS
- CONCRETE BLOCK PAVING ON EXISTING ROAD AND BACK OF SEAWALL
- NEW RAILING ALONG SEAWALL

- 新種植的樹及灌木與矮牆
- 步行徑
- 林蔭大道連接新計劃的公園
- 將鐵絲圍欄重置
- 保留現有的樹木
- 在現有的行人路種植開花灌木
- 在防波堤內的道路上鋪設混凝土磚
- 沿防波堤加建新欄杆

RAISED PLANTER WITH SEATWALL
高身花槽及矮矮牆

EXISTING ACACIA MANGIUM TREES
AND SHRUBS RETAINED
保留現有的大葉相思樹及灌木



EXISTING SITE PHOTO
油麻地避風塘北現狀

NEW RAILING ALONG SEAWALL
沿防波堤加建新欄杆

SHIP BOLLARD
RETAINED
保留繫船柱

1100

4000-5000

2000-3000

2500-3500

SECTION 1 剖面圖 1

EXISTING SEAWALL
現有的防波堤

CHAINLINK FENCE RELOCATED
將鐵絲圍欄重置

PROPOSED PARK
WITH FOOTPATH LINKS
TO WALKWAY
已計劃的公園行人路與步行徑相連

FOOTPATH
REPLACED WITH
FLOWERING SHRUBS
在現有的行人路種植開花灌木

LEGEND

- A - WALKWAY
- B - RAISED PLANTER WITH SEATWALL
- C - SHELTERED BOULEVARD WITH FOOTPATH LINKS TO NEW PARK

圖例

- A - 步行徑
- B - 高身花槽及矮矮牆
- C - 林蔭道連接新計劃的公園



RAILING REFERENCE PHOTO
欄杆參考照片

PLAN 平面圖

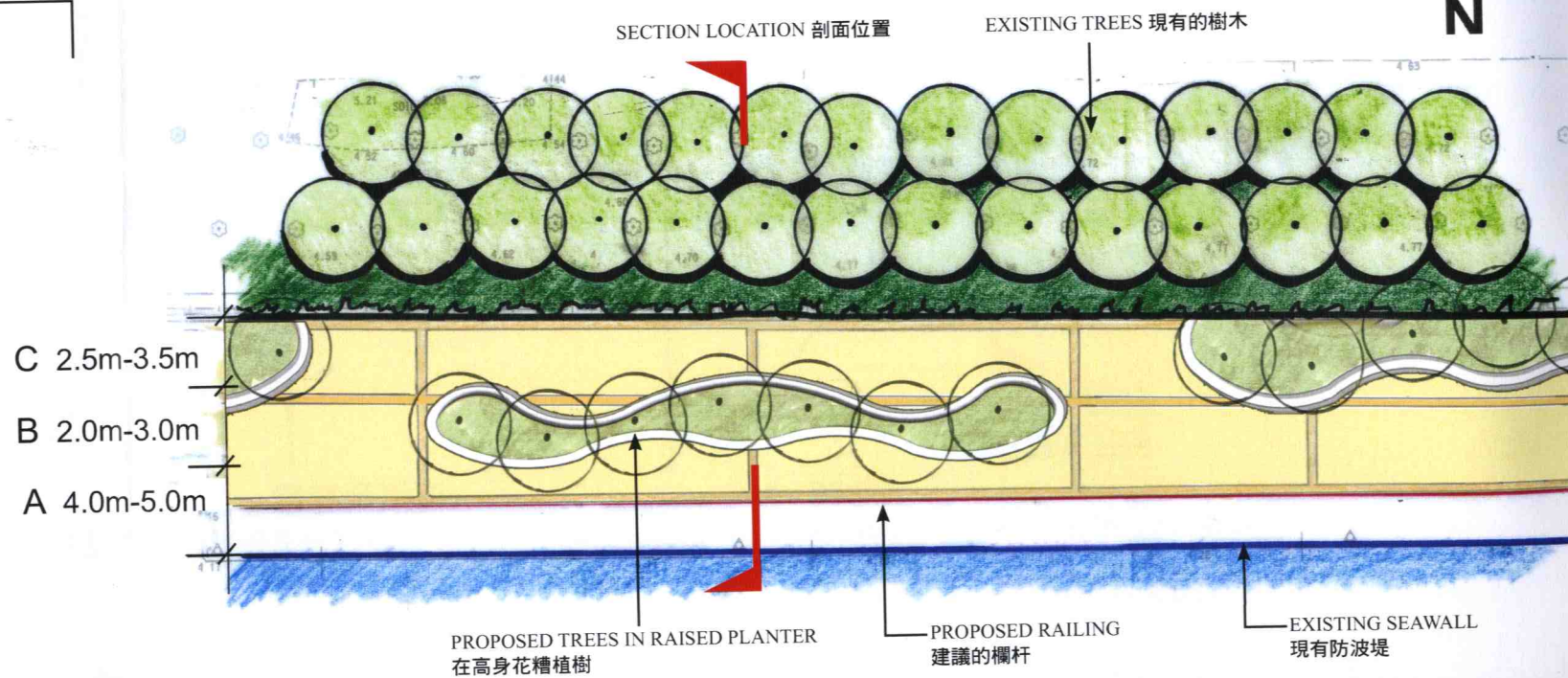

SHORT-TERM GREENING PROPOSAL AT NEW YAU MA TEI

TYPHOON SHELTER NORTH

新油麻地避風塘北短期綠化方案

SECTION - SCALE 1:50 @ A3

剖面圖 比例 1:50



REFERENCE IMAGE 參考圖片
NEW FERRY PIERS PROMENADE 新碼頭海濱行人路
CENTRAL RECLAMATION PHASE ONE 中環填海工程第一期

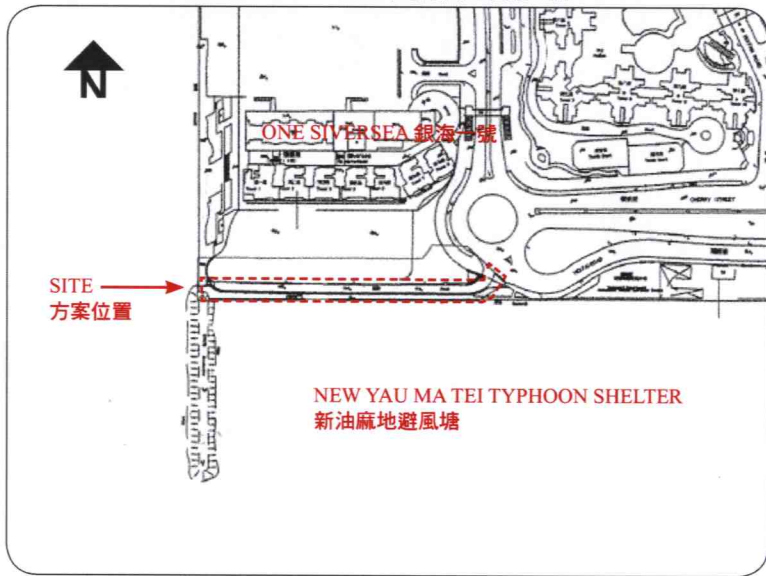

LEGEND
A - WALKWAY
B - RAISED PLANTER WITH SEATWALL

圖例
A - 步行徑
B - 高身花槽及矮矮牆



RAILING REFERENCE PHOTO
欄杆參考照片

DRAFT PROPOSAL 建議方案

- NEW TREE AND SHRUB PLANTER SET BACK TO NORTHERN BOUNDARIES
- FOOTPATH LINKS TO NEW PARK
- NEW RAILING ALONG SEAWALL

- 沿研究範圍北邊界線增加樹木及種植帶
- 行人道連接至新計劃的公園
- 沿防波堤加建新欄杆

AT-GRADE PLANTER WITH SEATWALL
種植帶及矮矮牆

EXISTING ACACIA MANGIUM TREES AND SHRUBS RETAINED
保留現有的大葉相思樹及灌木



EXISTING SITE PHOTO
油麻地避風塘北現狀

NEW RAILING ALONG SEAWALL
沿防波堤加建新欄杆

SHIP BOLLARD
RETAINED
保留繫船柱

1100

7000
A

2000-3000
B

SECTION 2 剖面圖 2

EXISTING SEAWALL
現有的防波堤

CHAINLINK FENCE RELOCATED
將鐵絲圍欄重置

PROPOSED PARK
WITH FOOTPATH LINKS
TO WALKWAY
已計劃的公園行人路與步行徑相連

FOOTPATH
REPLACED WITH
FLOWERING SHRUBS
在現有的行人路種植開花灌木

SECTION LOCATION 剖面位置

EXISTING TREES 現有的樹木

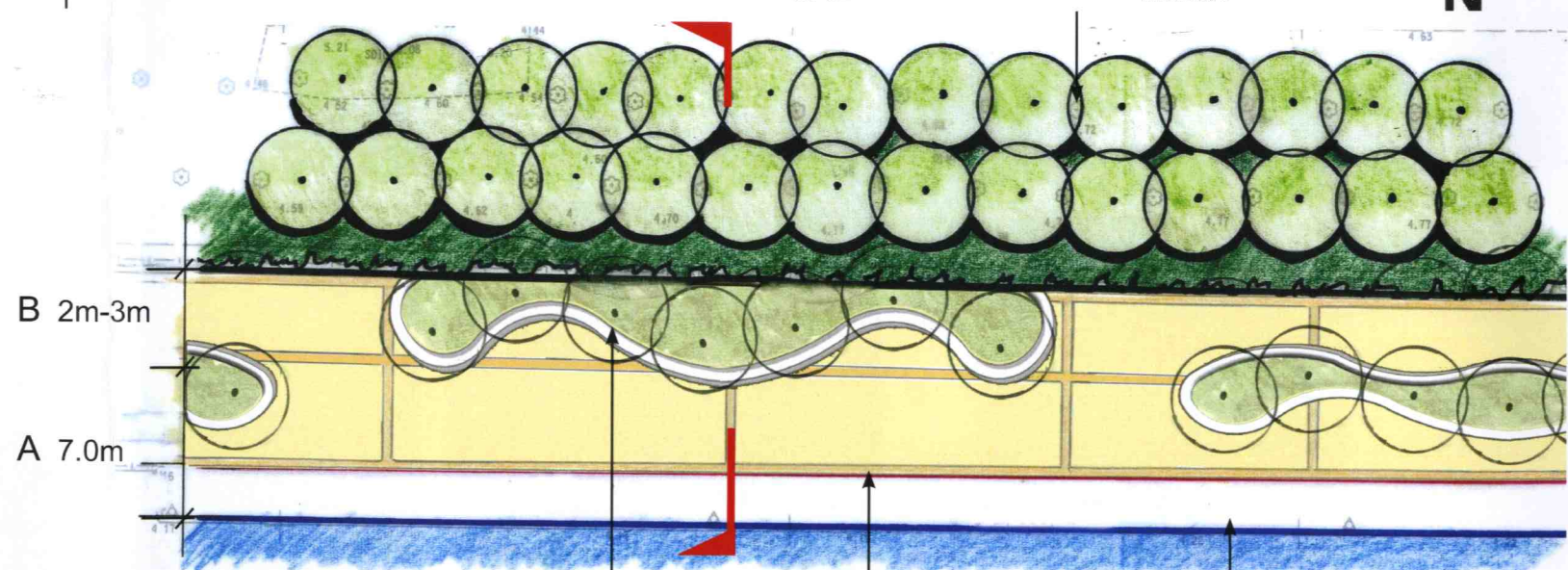

B 2m-3m

A 7.0m

PROPOSED TREES IN AT-GRADE PLANTER
在種植帶植樹

PROPOSED RAILING
建議的欄杆

EXISTING SEAWALL
現有防波堤

PLAN 平面圖

SPATIAL COMPARISON OF EXISTING PLANTERS AT CENTRAL FERRY PIERS WITH PROPOSED PLANTERS AT NEW YAU MA TEI TYPHOON SHELTER NORTH

中環港外線碼頭現有種植帶與新油麻地避風塘北綠化方案的景觀設計對比

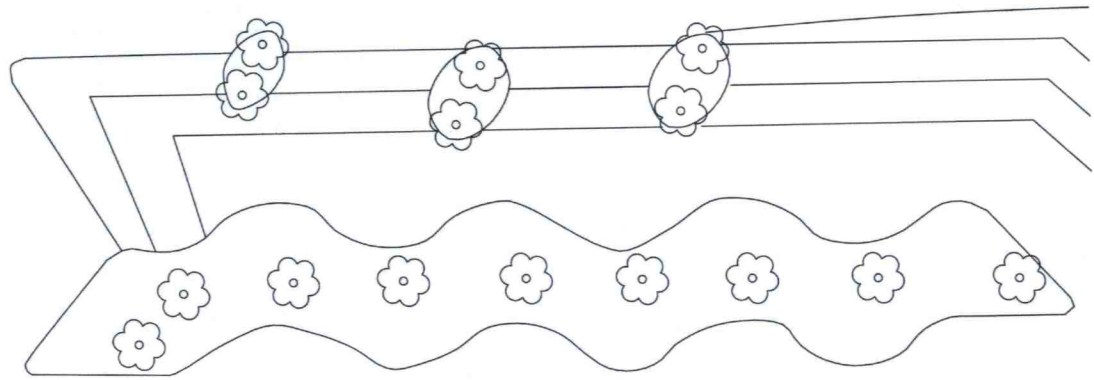

EXISTING PLANTER AT CENTRAL FERRY PIER 5
中環港外線五號碼頭現有種植帶樣式

APPROXIMATE 25 m
長度約25米



CENTRAL FERRY PIERS 中環港外線碼頭
RAISED PLANTER WITH SEATWALL 高身花槽及矮牆

REFERENCE PHOTOS 參考照片



NEW YAU MA TEI TYPHOON SHELTER 新油麻地避風塘
PROPOSED WALKWAY 建議的步行徑

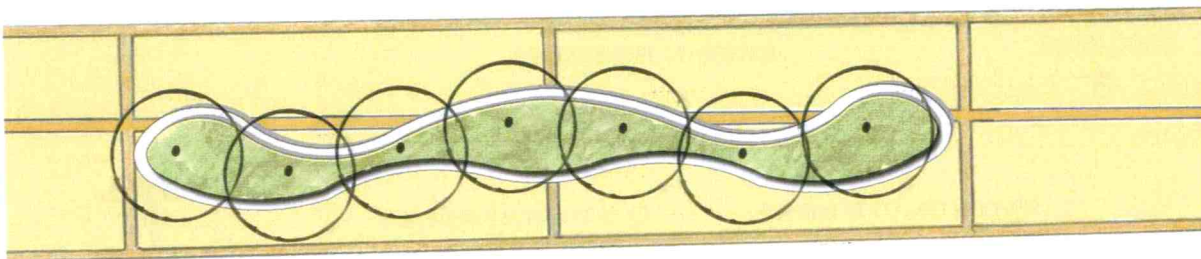

PROPOSED PLANTER AT YAU MA TEI TYPHOON SHELTER NORTH
新油麻地避風塘北建議種植帶樣式方案

THEME OF GREENING MASTER PLAN : COASTAL SCENERY
綠化總綱圖主題：海濱風光

SPECIES SELECTION 品種選擇



Ficus microcarpa 細葉榕



Rhododendron simsii 紅杜鵑



Ixora chinensis 龍船花



Schefflera arboricola 'Dazzle' 鵝掌藤



Terminalia catappa 欖仁樹



Hibiscus tiliaceus 黃槿



Duranta erecta 'Golden Leaves' 黃金假連翹



Cordyline terminalis 紅葉茱蕉



Hymenocallis littoralis 蜘蛛蘭



Ophiopogon japonicus 沿階草

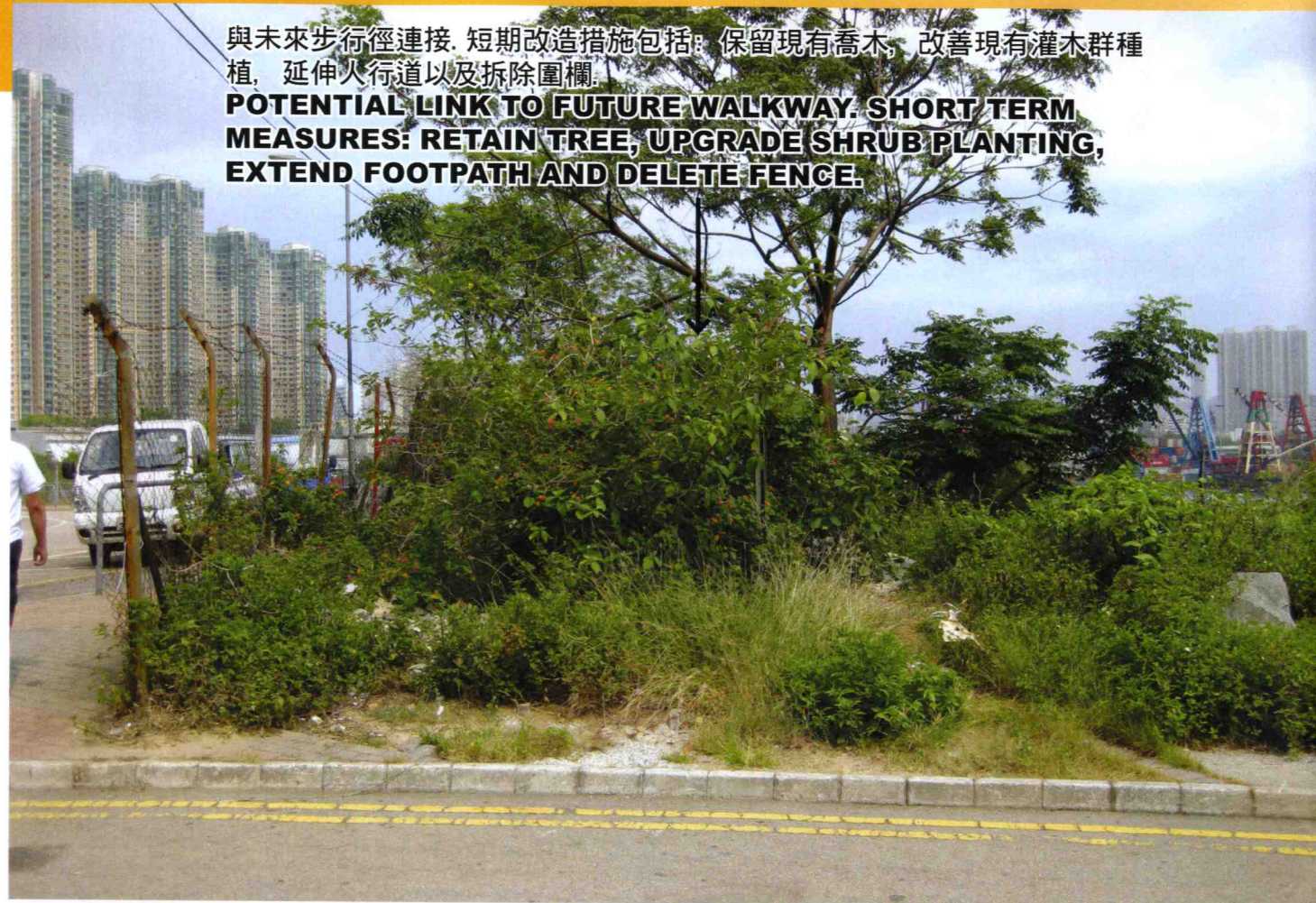

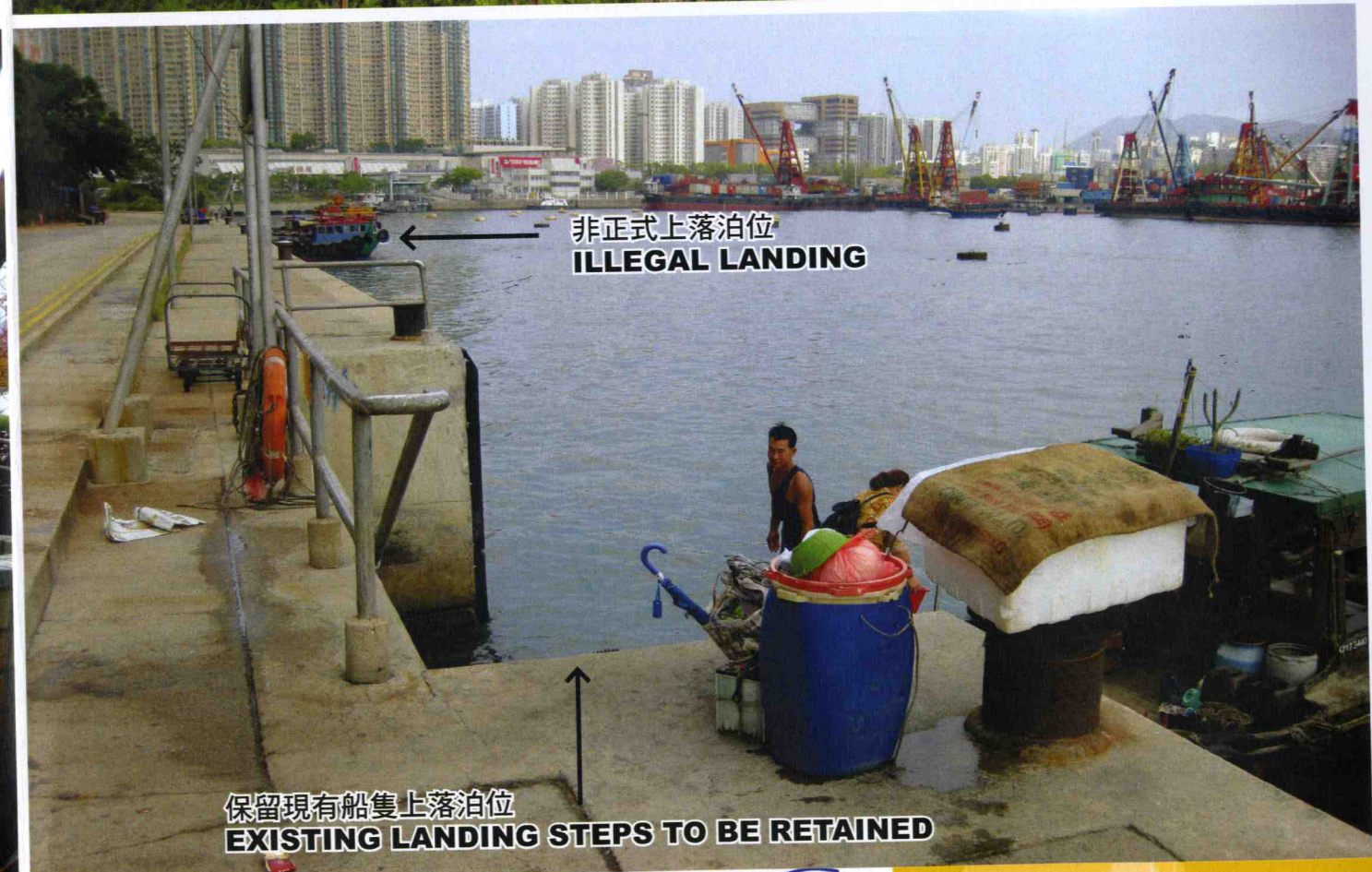
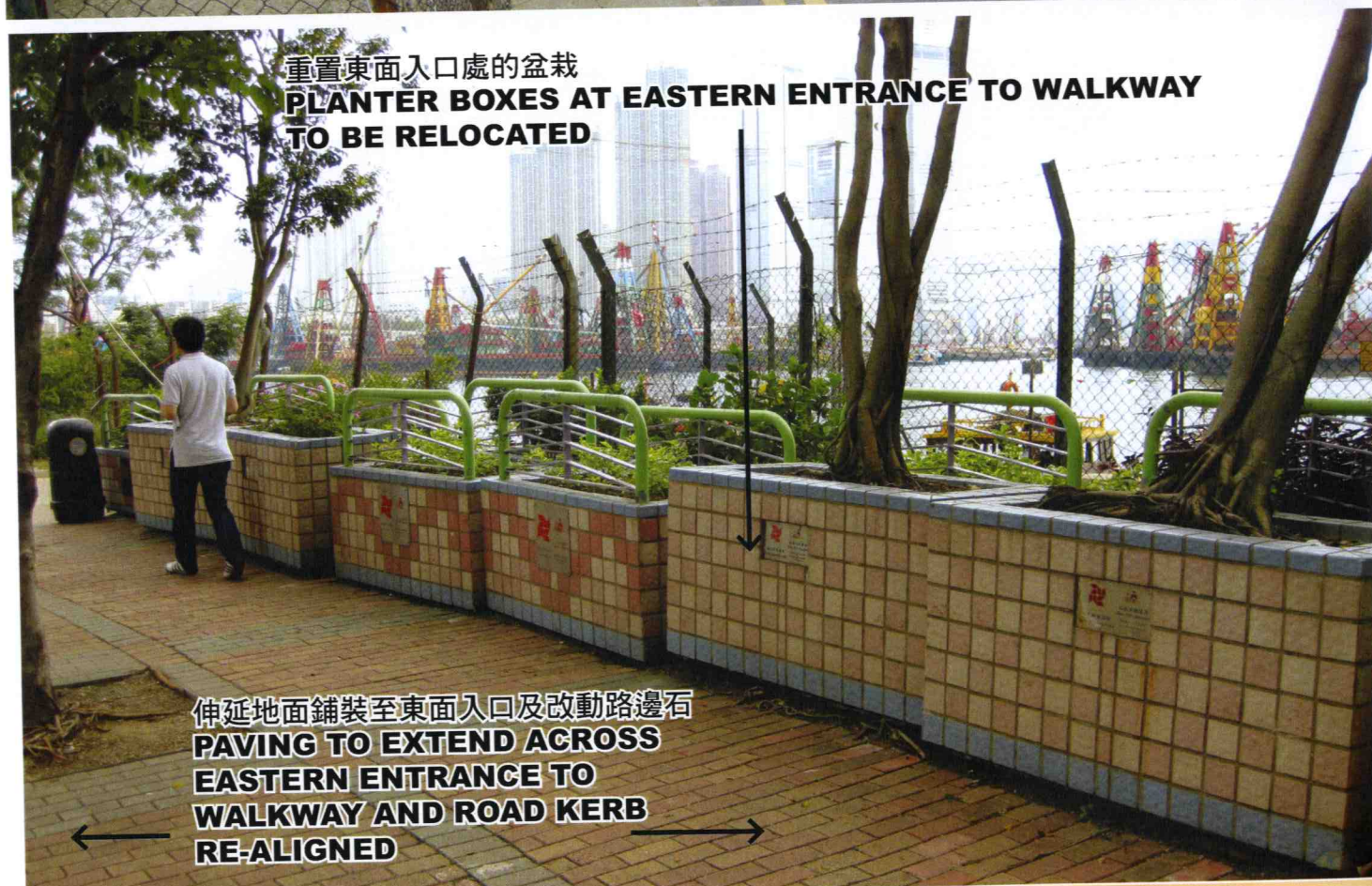
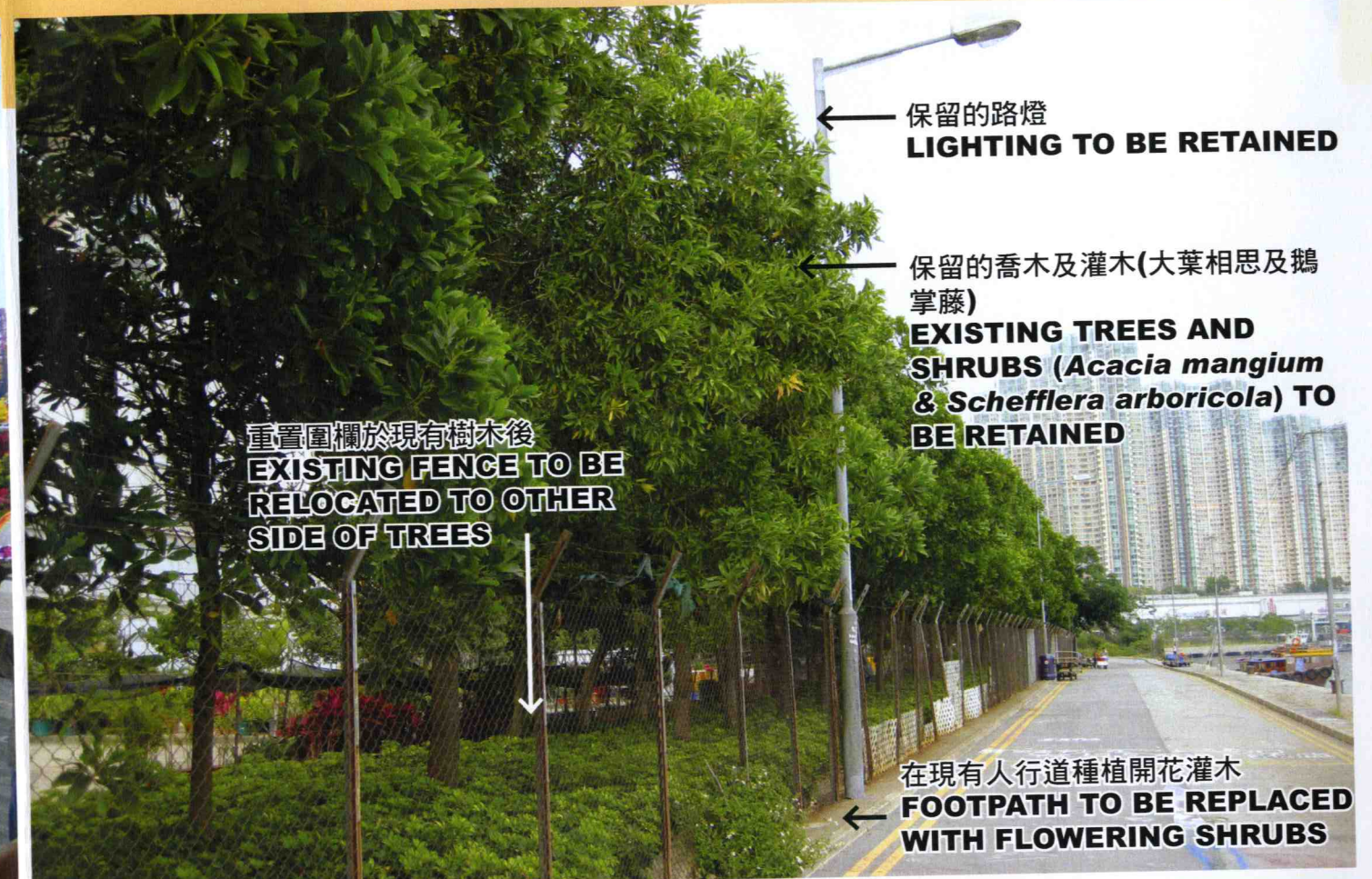
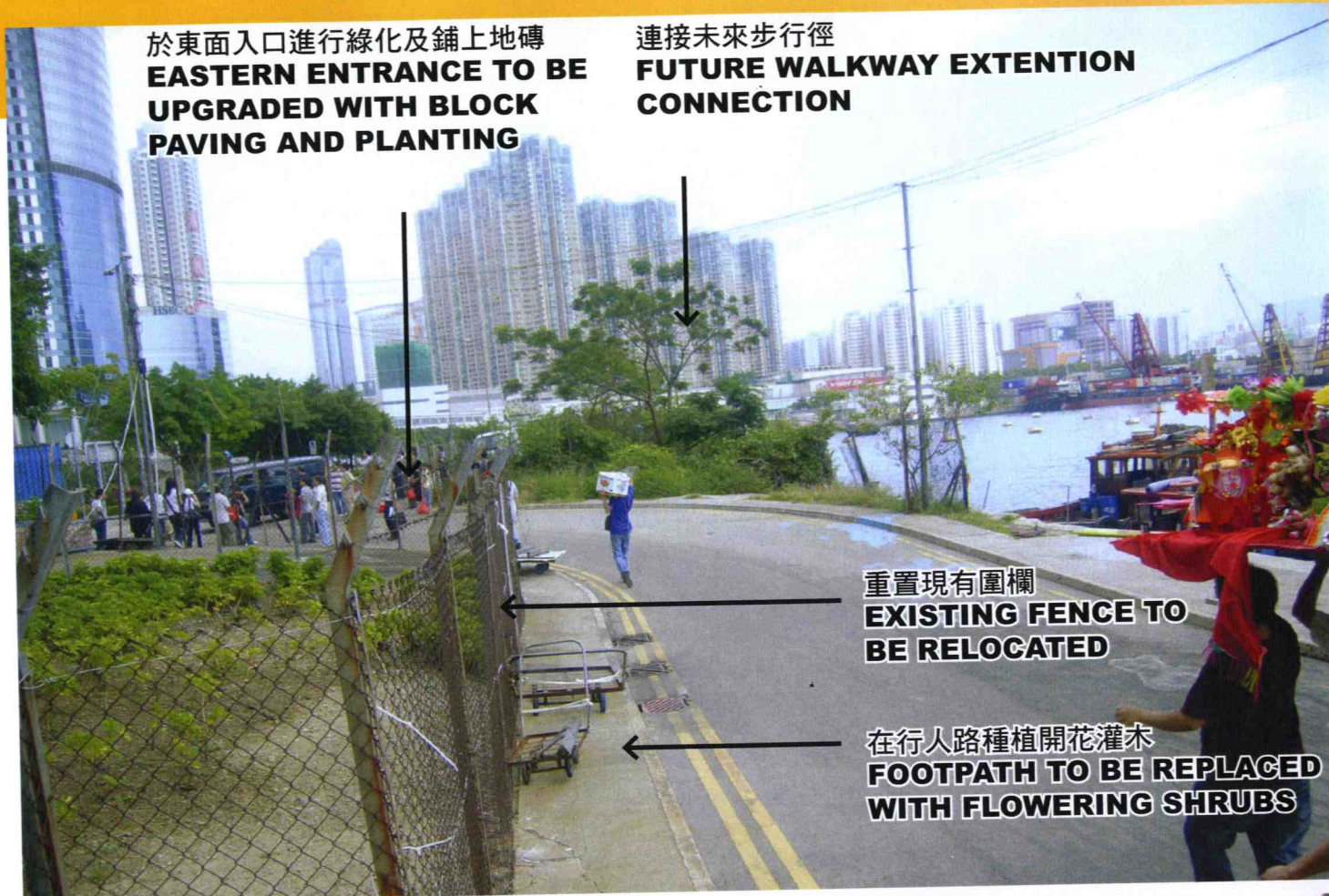

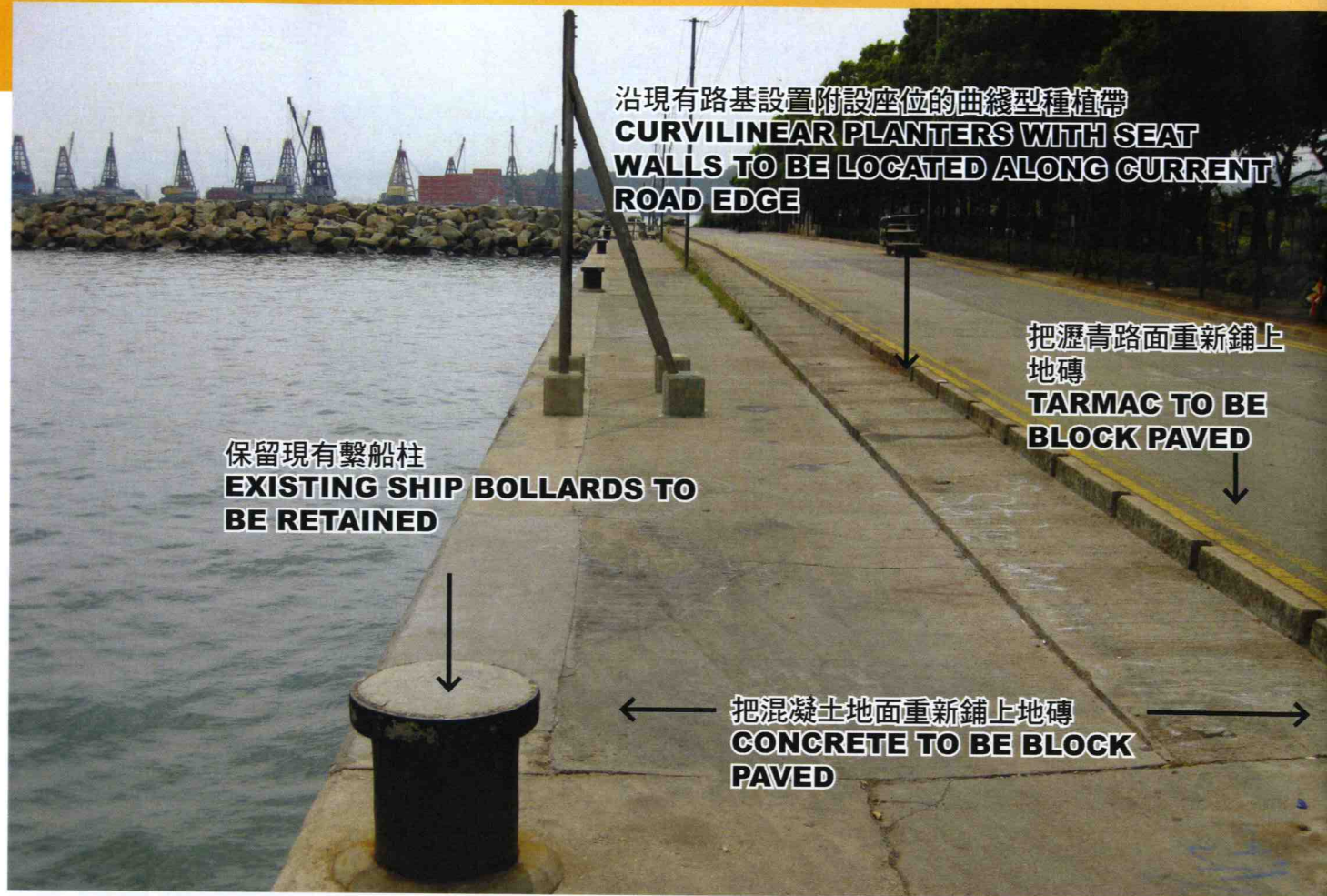



參考照片：中環天星碼頭的遮蔭喬木與矮牆種植槽 (詳見附件二)
REFERENCE PHOTO: CANOPY TREES AND SEATWALL PLANTERS AT CENTRAL FERRY PIERS (SEE APPENDIX II)

SHORT-TERM GREENING PROPOSAL AT NEW YAU MA TEI

TYPHOON SHELTER NORTH

新油麻地避風塘北短期綠化方案

REFERENCE PHOTO

參考照片