

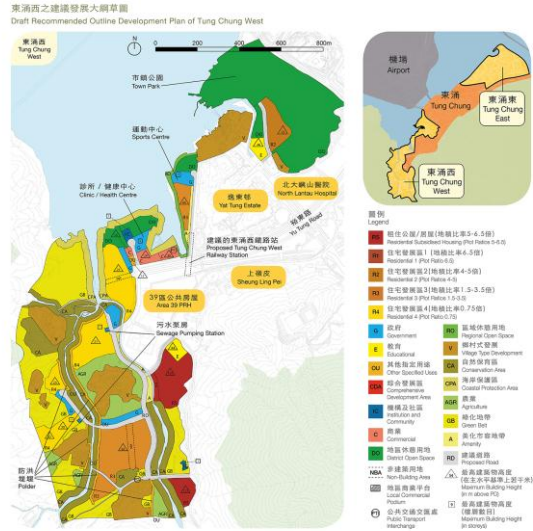

Major Projects of CEDD in Islands District

Project No/ Category	Project Title	Estimated Cost (Millions)	Bureau/ Department	Anticipated Commencement Date (Mth/Yr)	Anticipated Completion Date (Mth/Yr)	Engineering content / Remarks	Progress/ Current Status
712CL A	Planning and Engineering Study on Tung Chung New Town Extension – Feasibility Study	32.00	SDEV CEDD & PlanD	01/2012	09/2015	The study project comprises mainly the planning and engineering feasibility assessment of the potential extension area in Tung Chung. It consists of impact assessments on environment, landscape, ventilation, traffic and local ecology.	Stage 3 Public Engagement for soliciting public comments on the draft Recommended Outline Development Plan (RODP) was accomplished in end October 2014. The public generally support the proposed development and urge for an early implementation. We are now refining the RODP taking into account the public views collected and undertaking the statutory environmental impact assessment
<div><div><p>東涌西之建議發展大綱草圖 Draft Recommended Outline Development Plan of Tung Chung West</p></div><div><p>東涌東之建議發展大綱草圖 Draft Recommended Outline Development Plan of Tung Chung East</p></div></div>							

Major Projects of CEDD in Islands District

Project No/ Category	Project Title	Estimated Cost (Millions)	Bureau/ Department	Anticipated Commencement Date (Mth/Yr)	Anticipated Completion Date (Mth/Yr)	Engineering content / Remarks	Progress/ Current Status
742CL A	Main engineering infrastructure in association with the proposed developments at Area 56 in Tung Chung	54.80	Transport and Housing Bureau Civil Engineering and Development Department	09/2014	05/2016	The project comprises road, drainage and water supply works to support the development in that area.	The statutory gazette procedures under the Roads (Works, Use and Compensation) Ordinance (Cap.370) were completed. The construction works commenced in September 2014 for completion in May 2016.

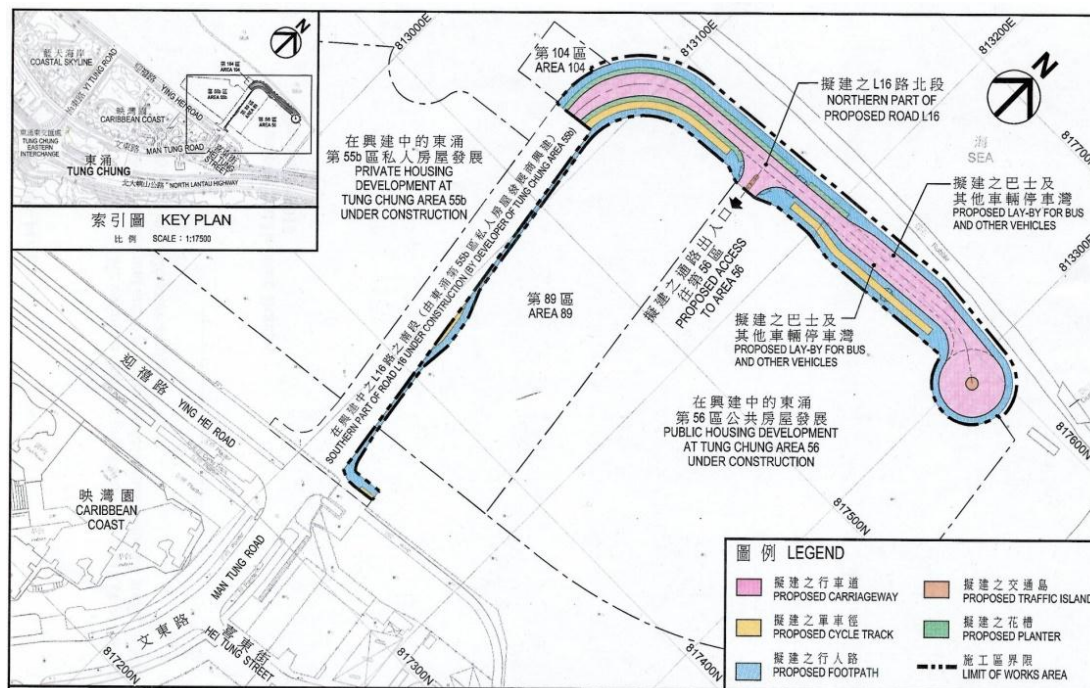

Major Projects of CEDD in Islands District

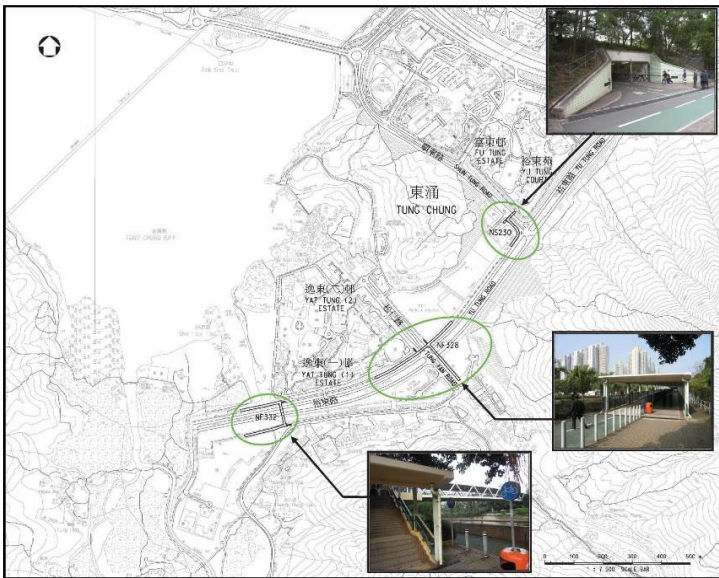
Project No/ Category	Project Title	Estimated Cost (Millions)	Bureau/ Department	Anticipated Commencement Date (Mth/Yr)	Anticipated Completion Date (Mth/Yr)	Engineering content / Remarks	Progress/ Current Status
6101TX D	Provision of Universal Access Facilities at Public Footbridges, Elevated Walkways & Subways Package 2 – Investigation, Design and Construction y	147.00	STH CEDD	10/2015	10/2017	<p>The project aims to provide lift facilities for the following three public footbridges/subway in Islands district:</p> <ol style="list-style-type: none"> 1. Footbridge across Yu Tung Road and Chung Yan Road (Structure No. NF328); 2. Footbridge across Yu Tung Road near Tung Chung Ha Ling Pei (Structure No. NF332); and 3. Pedestrian subway across Shun Tung Road near Lantau North Divisional Police Station (Structure No. NS230). 	<p>CEDD reported the result of the technical feasibility study and relevant preliminary schemes of the project to the Traffic and Transport Committee of Islands District Council on 20 January 2014. The proposals were supported by the Committee. Detailed design of the project is in progress. Construction works are scheduled to commence in end 2015 for completion in end 2017</p>
							

Major Projects of CEDD in Islands District

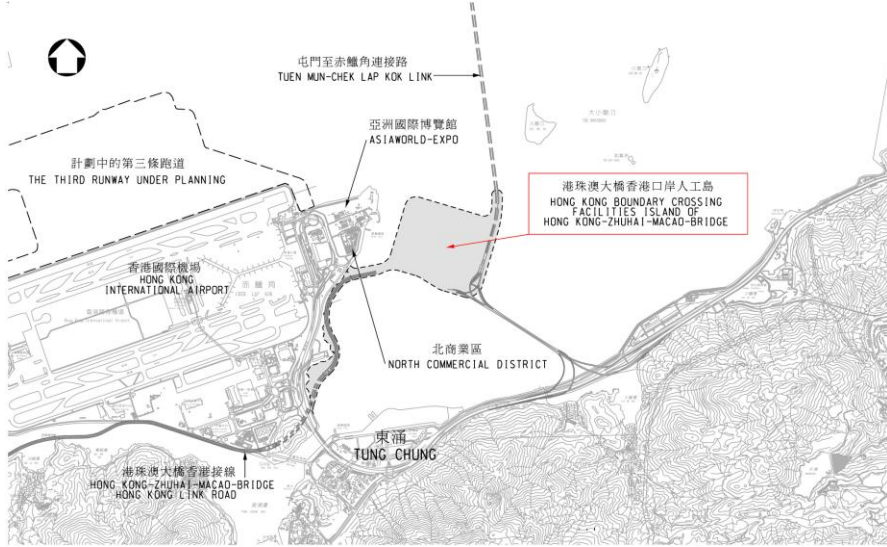
Project No/ Category	Project Title	Estimated Cost (Millions)	Bureau/ Department	Anticipated Commencement Date (Mth/Yr)	Anticipated Completion Date (Mth/Yr)	Engineering content / Remarks	Progress/ Current Status
770CL A	Planning, engineering and architectural study for topside development at Hong Kong boundary crossing facilities island of Hong Kong-Zhuhai-Macao Bridge	63.40	SDEV PlanD & CEDD	01/2015 (Actual)	02/2017	The project comprises a planning, engineering and architectural study for the proposed commercial development and the development of other economic activities at the Hong Kong boundary crossing facilities island of Hong Kong-Zhuhai-Macao Bridge and the associated site investigation works	The funding application was approved by the Finance Committee on 16 January 2015. The study commenced on 23 January 2015 for completion in February 2017.
							

Major Projects of CEDD in Islands District

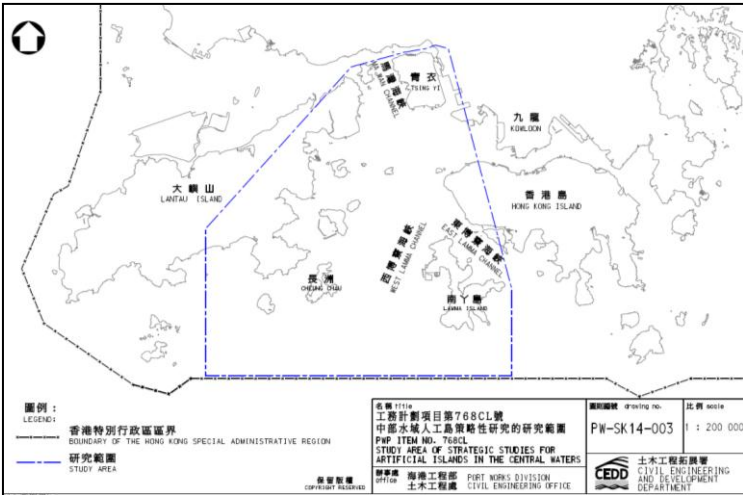
Project No/ Category	Project Title	Estimated Cost (Millions)	Bureau/ Department	Anticipated Commencement Date (Mth/Yr)	Anticipated Completion Date (Mth/Yr)	Engineering content / Remarks	Progress/ Current Status
5768CL B	Strategic studies for artificial islands in the central waters	(The item was withdrawn at the PWSC meeting on 26.11.2014. The estimated cost of this item is under review.)	SDEV CEDD	(The item was withdrawn at the PWSC meeting on 26.11.2014. The implementation programme of this item is under review.)	(The item was withdrawn at the PWSC meeting on 26.11.2014. The implementation programme of this item is under review.)	The project scope comprises strategic studies on building artificial islands in the Central Waters covering preliminary engineering study including broad reclamation extent and transport links, preliminary planning proposals including possible land uses, port operations and marine traffic and safety study, strategic environmental assessment, fisheries impact assessment, consultation exercises with relevant stakeholders and associated site investigation works including supervision	The item was withdrawn at the PWSC meeting on 26.11.2014. The implementation programme of this item is under review.
							

Major Projects of CEDD in Islands District

Project No/ Category	Project Title	Estimated Cost (Millions)	Bureau/ Department	Anticipated Commencement Date (Mth/Yr)	Anticipated Completion Date (Mth/Yr)	Engineering content / Remarks	Progress/ Current Status
448RO A	Improvement works at Mui Wo, phase 1	193.10	SDEV CEDD	07/2014	09/2016	<p>The Improvement works at Mui Wo, phase 1 which include the following –</p> <p>(a) a 230-metre (m) long and 11.5-m wide segregated pedestrian walkway and cycle track along the waterfront between Mui Wo Cooked Food Market and River Silver;</p> <p>(b) a 35-m long and 4.8-m wide footbridge across River Silver;</p> <p>(c) a civic square near Mui Wo old town provided with associated landscaped area</p>	Works commenced in July 2014 for completion in late 2016.

Major Projects of CEDD in Islands District

Project No/ Category	Project Title	Estimated Cost (Millions)	Bureau/ Department	Anticipated Commencement Date (Mth/Yr)	Anticipated Completion Date (Mth/Yr)	Engineering content / Remarks	Progress/ Current Status
						(d) seven amenity areas in villages at Mui Wo; and (e) ancillary works including information boards, signage, landscaping, drainage and utilities works.	

Major Projects of CEDD in Islands District

Project No/ Category	Project Title	Estimated Cost (Millions)	Bureau/ Department	Anticipated Commencement Date (Mth/Yr)	Anticipated Completion Date (Mth/Yr)	Engineering content / Remarks	Progress/ Current Status
414RO-2A B	Improvement works at Mui Wo – Phase 2 Stage 1	72.31	SDEV CEDD	Under review	Under review	This project contains the Phase 2 Stage 1 works of the proposed Improvement works at Mui Wo. Phase 2 Stage 1 works include realignment of Mui Wo Ferry Pier Road and extension of an existing car park.	Detailed design of the proposed works is being carried out. Statutory procedures for gazettal are in progress.
							

Major Projects of CEDD in Islands District

Project No/ Category	Project Title	Estimated Cost (Millions)	Bureau/ Department	Anticipated Commencement Date (Mth/Yr)	Anticipated Completion Date (Mth/Yr)	Engineering content / Remarks	Progress/ Current Status
414RO B	Improvement works at Mui Wo – Remaining Phases	496.00	SDEV CEDD	04/2018	05/2020	<p>This project contains the remaining works of the proposed Improvement works at Mui Wo. Phase 2 Stage 2 and Phase 3 works include reprovision of cooked food market, beautification of the south waterfront promenades and entrance plaza; and improvement of existing cycle tracks.</p>	<p>Detailed design of the proposed works is in progress. The commencement and completion dates are tentative and under review.</p>
<p>The map illustrates the layout of Mui Wo and the locations of various improvement projects. Key areas highlighted include:</p> <ul style="list-style-type: none"> Phase 1 Works: <ul style="list-style-type: none"> PROPOSED CIVIC SQUARE (near Silvermine Cave) PROPOSED FOOTBRIDGE ACROSS RIVER SILVER PROPOSED SEGREGATED PEDESTRIAN WALKWAY AND CYCLE TRACK Remaining Works (Phase 2 Stage 2 and Phase 3): <ul style="list-style-type: none"> REPROVISION OF COOKED FOOD MARKET AND COVERED CYCLE PARKING AREA MUI WO FERRY PIER ENHANCEMENT OF ENTRANCE PLAZA IMPROVEMENT TO SOUTH WATERFRONT REPROVISION OF CARGO LOADING AND UNLOADING AREA PROVISION/IMPROVEMENT OF CYCLE TRACK NETWORK AND HERITAGE TRAIL IN MUI WO REALIGNMENT OF MUI WO FERRY PIER ROAD AND MODIFICATION OF CAR PARK 							

Major Projects of CEDD in Islands District

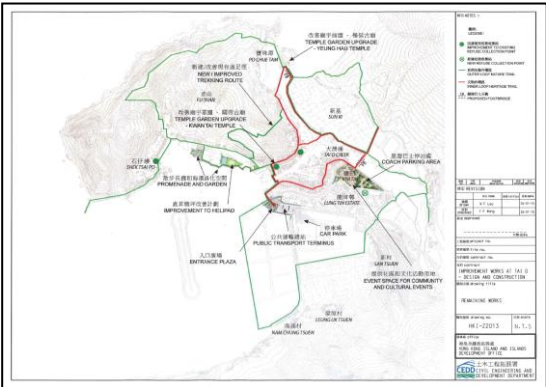
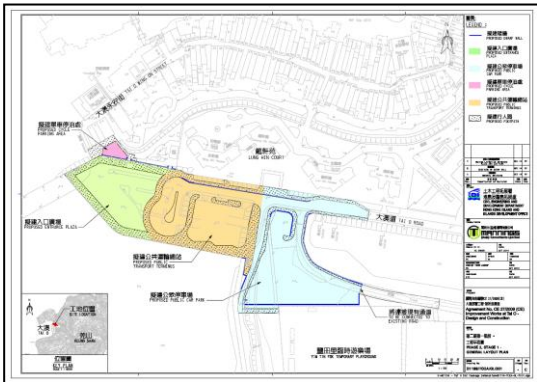
Project No/ Category	Project Title	Estimated Cost (Millions)	Bureau/ Department	Anticipated Commencement Date (Mth/Yr)	Anticipated Completion Date (Mth/Yr)	Engineering content / Remarks	Progress/ Current Status
417RO B	Improvement works at Tai O, remaining works	1,295.00	SDEV CEDD	03/2016	12/2021	The project aims at implementing the remaining improvement works of the Concept Plan for Revitalisation of Tai O, which includes strengthening the infrastructures of external linkage and facilities, preserving the cultural heritage and natural attributes of Tai O for its visitor appeal, as well as providing other infrastructural support.	The detailed design of the works in the remaining stages is in progress. The construction works will be carried out in phases. The commencement and completion dates of the remaining stages are preliminary estimates. They will be reviewed in the detailed design stage.
 <p>Improvement Works at Tai O- Remaining Works</p>			 <p>Phase 2 Stage 1 of the</p>			<p>The Phase 2 Stage 1 of the remaining works had been consulted Islands District Council (IsDC) on 15 December 2014 and gained support from the IsDC members. Gazettal procedure for the project will be commenced soon. The project comprises</p>	

Major Projects of CEDD in Islands District

Project No/ Category	Project Title	Estimated Cost (Millions)	Bureau/ Department	Anticipated Commencement Date (Mth/Yr)	Anticipated Completion Date (Mth/Yr)	Engineering content / Remarks	Progress/ Current Status
						construction of an entrance plaza, a public transport terminus and a public car park. The proposed works aim at improving the traffic circulation of different types of road users at the concerned area, increasing the car parking space and providing an entrance plaza so as to enhance the tourist handling capacity at Tai O. In addition, a designated cycle parking area will be provided to avoid illegal parking of bicycles which can improve the streetscape.	

Major Projects of CEDD in Islands District

Project No/ Category	Project Title	Estimated Cost (Millions)	Bureau/ Department	Anticipated Commencement Date (Mth/Yr)	Anticipated Completion Date (Mth/Yr)	Engineering content / Remarks	Progress/ Current Status
To be confirmed	Mountain Bike Trail Networks in South Lantau	About 45	DEVB/ CEDD	Q4 2015	Q4 2017	Improvement of Mountain Bike Trail (MBT) networks in South Lantau for public enjoyment : <ul style="list-style-type: none">- Local improvements to existing MBTs- Construction of new trails to expand the network- Improvement works to form gathering places at Chi Ma Wan MBT and Mui Wo – Pui O MBT Trailheads- Construction of a new training ground at Lai Chi Yuen Tsuen- Ancillary measures (e.g. signage, distance posts, railings, etc.)	We are now preparing to engage consultants to design and supervise the construction of the works, which is scheduled to start by 4 th quarter 2015.
<div><div><div><div><div>Legend 圖例</div><div><div><div><div><div><div>--- Feasibility Study Area 可行性研究範圍</div><div>Existing Mountain Bike Trails for Improvement 現有越野單車徑改善工程</div><div>- - - Proposed New Mountain Bike Trails 擬建新越野單車徑</div><div>■ Proposed Training Ground 擬建新練習場地</div><div>★ Gathering Place at Mui Wo Ferry Pier Road 擬建越野單車人士集合地點-梅窩碼頭道旁</div><div>★ Gathering Place at the Entrance of Chi Ma Wan Country Trail 擬建越野單車人士集合地點-芝罘灣郊遊徑入口處</div></div></div></div></div><div></div><div><div>Mountain Bike Trail Networks in South Lantau - Feasibility Study Recommended Scheme 南大嶼山越野單車徑網絡 - 可行性研究建議方案</div><div><div><div>Drawing No. 圖號</div><div>Scale 比例尺</div><div>1:50000</div></div><div><div>Checked 校核</div><div>Date 日期</div></div><div><div>Approved 核准</div><div>Date 日期</div></div></div><div><div> 土木工程師署 Civil Engineering and Development Department</div></div></div></div></div></div></div></div>							

Major Projects of CEDD in Islands District

Project No/ Category	Project Title	Estimated Cost (Millions)	Bureau/ Department	Anticipated Commencement Date (Mth/Yr)	Anticipated Completion Date (Mth/Yr)	Engineering content / Remarks	Progress/ Current Status
7100CX 7D67CL D	Planning and Engineering Study on Future Land Use at Ex-Lamma Quarry Area at Sok Kwu Wan, Lamma Island – Feasibility Study	29.90	SDEV PlanD & CEDD	01/2012	09/2016	<p>The study includes the formulation of various land use options for the ex-Lamma Quarry at Sok Kwu Wan in Lamma Island, and the related planning and engineering study as well as environmental impact assessment.</p> <p>The Study Site comprises 20 hectares of platform area, 1 kilometre of shoreline and a 5-hectare man-made lake.</p>	<p>The Stage 2 Community Engagement comprising focus group meetings, briefing sessions and public forum were held from March to May 2014. A briefing to LegCo Panel on Development was also held on July 2014.</p> <p>The RODP and layout plans will be finalised during the finalisation stage of study.</p>
							

Major Projects of CEDD in Islands District

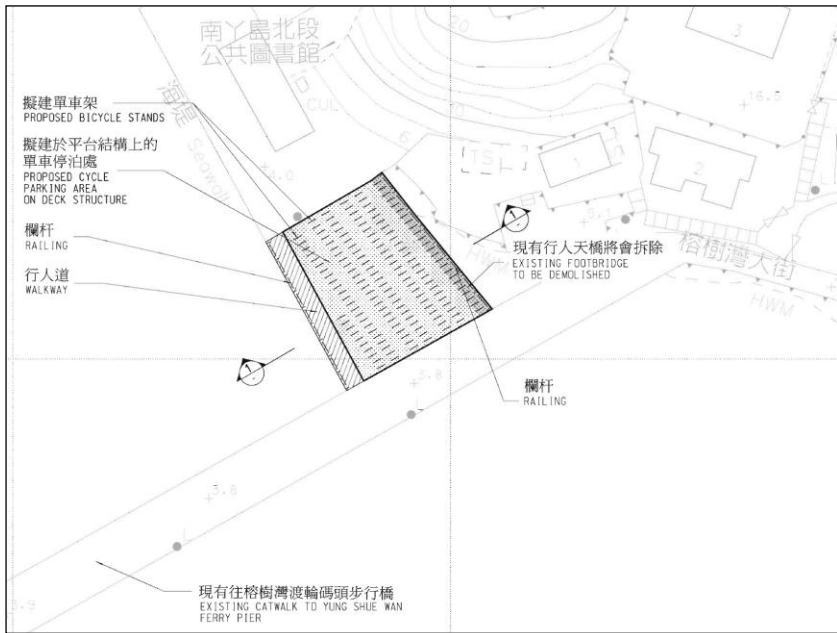
Project No/ Category	Project Title	Estimated Cost (Millions)	Bureau/ Department	Anticipated Commencement Date (Mth/Yr)	Anticipated Completion Date (Mth/Yr)	Engineering content / Remarks	Progress/ Current Status
IS 256 D	Construction of Cycle Parking Area near Yung Shue Wan Ferry Pier, Lamma Island	26.50	Home Affairs Department CEDD	12/2013	6/2015	The project scope comprises construction of a cycle parking area (CPA) of 350m2 approximately. Upon completion, the CPA provides about 300 parking spaces for bicycles.	Piling works have been completed. Contruction of structural steel platform was in progress.
							

Major Projects of CEDD in Islands District

Project No/ Category	Project Title	Estimated Cost (Millions)	Bureau/ Department	Anticipated Commencement Date (Mth/Yr)	Anticipated Completion Date (Mth/Yr)	Engineering content / Remarks	Progress/ Current Status
5101CX 5G66CG D	Greening Master Plan (GMP)s of the South West New Territories (SWNT) – Consultancy Study & Site Investigation	18.10 (including the cost on Islands, Tsuen Wan and Kwai Tsing)	SDEV CEDD	02/2012 (Study commenced)	07/2015 (GMPs formulation completed)	The scope of works includes formulation of the GMPs of SWNT (including Islands, Tsuen Wan and Kwai Tsing) and the detailed design and necessary site investigation for the greening measures.	The detailed design is in progress and it is anticipated that the design would be completed in mid-2015.

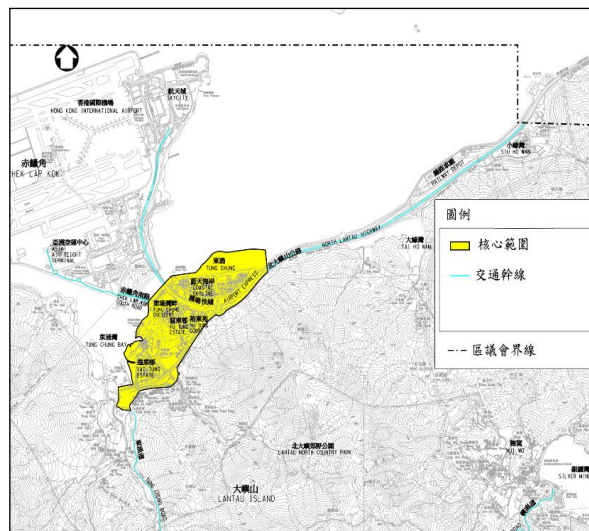

Tung Chung GMP Focal Area

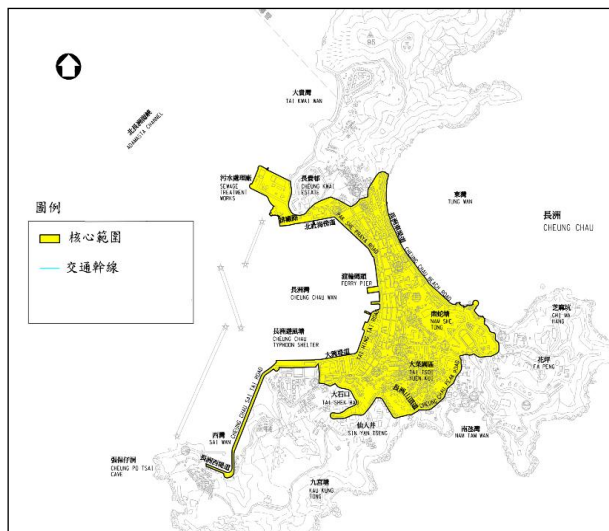

Cheung Chau GMP Focal Area

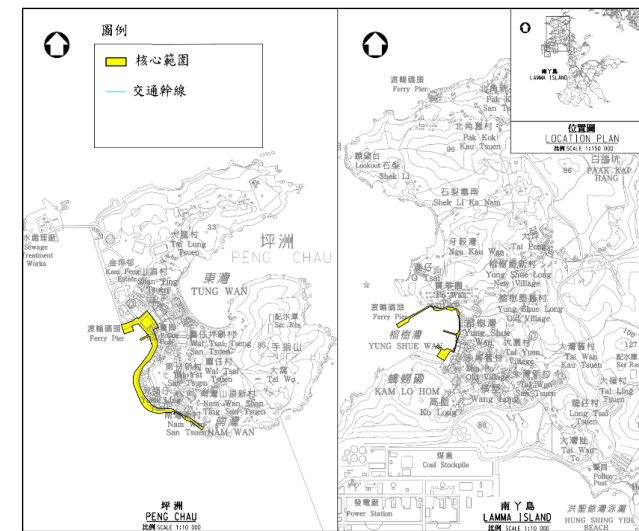

Peng Chau and Lamma Island GMPs Focal Area

Major Projects of CEDD in Islands District

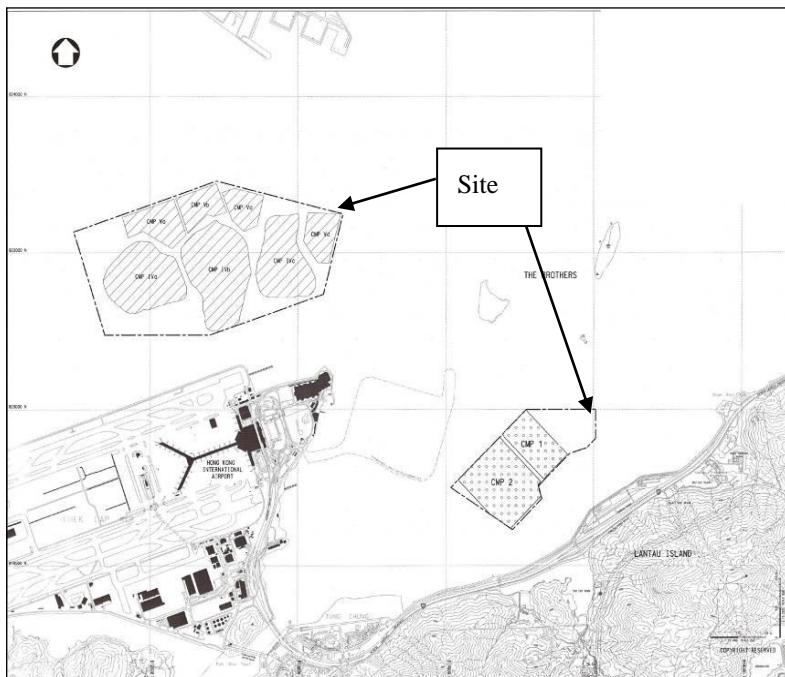
Project No/ Category	Project Title	Estimated Cost (Millions)	Bureau/ Department	Anticipated Commencement Date (Mth/Yr)	Anticipated Completion Date (Mth/Yr)	Engineering content / Remarks	Progress/ Current Status
737CL A	Dredging, management and capping of contaminated sediment disposal facility to the south of The Brothers	469.13	SDEV CEDD	09/2012	12/2018	The project comprises the formation of 2 sediment disposal pits at the seabed to the south of The Brothers for the disposal of about 4 million cubic metres sediment; on-site control of mud disposal activities; and implementation of an Environmental Monitoring and Audit (EM&A) programme.	The first mud pit was commissioned to receive contaminated sediment in late August 2013 and was filled up in end November 2014 when capping commenced. The dredging of the second mud pit was completed and contaminated sediment disposal commenced thereat in end November 2014. All the disposal and capping works are expected to be completed in end 2016 whereas the EM&A will continue until end 2018.
 <p>The map shows the geographical context of the project. It includes the Hong Kong International Airport, Lantau Island, and the area south of The Brothers. Two specific disposal pits are highlighted: CMP 1 and CMP 2. A box labeled 'Site' with arrows points to these locations. The map also shows various other features like roads, railways, and other land parcels.</p>							

Major Projects of CEDD in Islands District

Project No/ Category	Project Title	Estimated Cost (Millions)	Bureau/ Department	Anticipated Commencement Date (Mth/Yr)	Anticipated Completion Date (Mth/Yr)	Engineering content / Remarks	Progress/ Current Status
114AP A	Providing Sufficient Water Depth for Kwai Tsing Container Basin and its Approach Channel	476.85	THB CEDD	08/2013	02/2016	The project comprises mainly dredging the sea-bed of Kwai Tsing Container Basin and portions of the Northern and Western Fairways (a total area of 428 ha) to a depth of 17.5 metres (m) below Chart Datum.	The works commenced in August 2013 and is expected to be completed by February 2016.
							

Major Projects of CEDD in Islands District

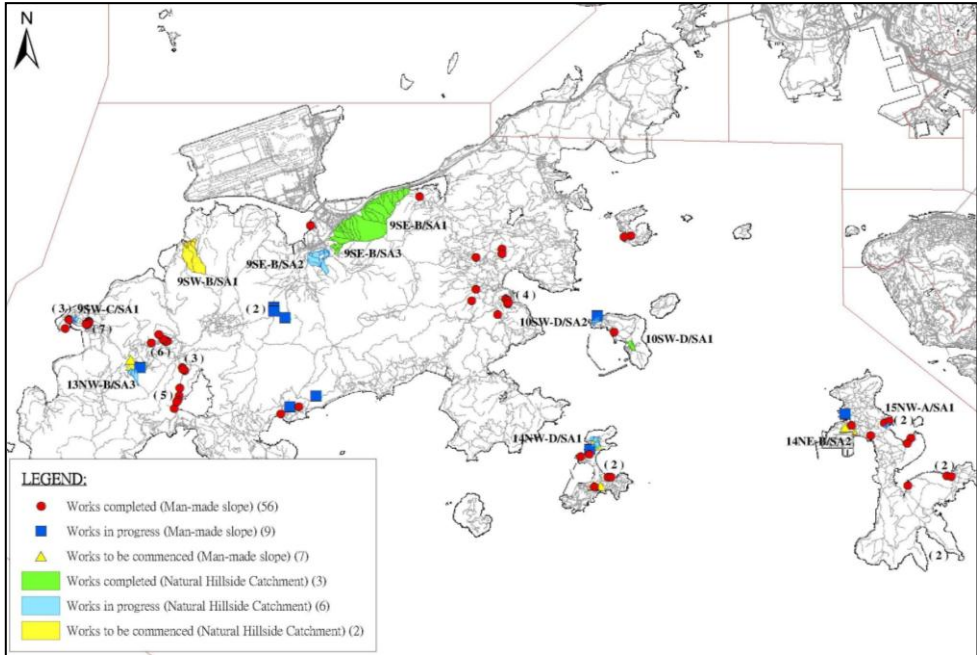
Project No/ Category	Project Title	Estimated Cost (Millions)	Department	Commencement Date (Mth/Yr)	Completion Date (Mth/Yr)	Engineering content / Remarks	Progress/ Current Status
Head 705 Subhead 5001BX	Landslip Prevention and Mitigation Programme (LPMitP)	1,015 (Estimated expenditure for Financial Year 2014/15)	CEDD	2010	In progress	Landslip Prevention and Mitigation (LPMit) works for 56 man-made slopes and 3 natural hillside study areas in Islands District are completed.	The works are scheduled to be completed by early of 2017
 <p>Landslip Prevention and Mitigation Works in Southern District</p>						<p>The LPMit works for 9 man-made slopes in Islands District are in progress. The details are:</p> <ul style="list-style-type: none"> ● 3 Slope Nos. 9SE-C/C57 、 9SE-C/C86 and 9SE-C/CR25 at Tei Tong Tsai, Lantau Island; ● 1 Slope No. 10SW-D/F11 at Hei Ling Chau Treatment Centre; ● 1 Slope No. 13NE-A/C49 at Ma Po Ping Road, Lantau Island; ● 1 Slope No. 13NE-B/CR155 at Catchwater near Tong Fuk and Butterfly Creat, South Lantau Island; ● 1 Slope No. 13NW-B/C175 at Tai O Road, Lantau Island; ● 1 Slope No. 14NE-B/CR203 at Yung Shue Wan Main Street, Lamma Island; and ● 1 Slope No. 14NW-D/C57 at Tai Kwai Wan San Tsuen, Cheung Chau. 	

Major Projects of CEDD in Islands District

Project No/ Category	Project Title	Estimated Cost (Millions)	Department	Commencement Date (Mth/Yr)	Completion Date (Mth/Yr)	Engineering content / Remarks	Progress/ Current Status
						<p>The LPMit works for another 1 natural hillside study areas at Fui Yiu Ha, Tung Chung, 1 natural hillside study area above Tai O Substation in Shek Tsai Po street, Lantau Island, 1 natural hillside study area above Hei Ling Chau Officers' Mess, 1 natural hillside study area at Lower Keung Shan, Lantau Island, 1 natural hillside study area behind Scenic Garden, Cheung Chau and 1 natural hillside study area above Lo Tik Wan, Lamma Island are also in progress.</p> <p>CEDD plan to progressively commence the LPMit works for another 7 man-made slopes and 2 natural hillside study areas in Islands District in the coming year.</p>	<p>The works are scheduled to be completed by early of 2017.</p> <p>The anticipated completion dates of the works are by the early of 2017.</p>