

## **Update on the ‘Airport City’ projects at Hong Kong International Airport**

### **Purpose**

1. Airport Authority Hong Kong (AAHK) briefed members of the Islands District Council (the Council) at the meeting on 27 July 2021 about the “Airport City” projects at Hong Kong International Airport (HKIA) (Paper IDC 46/2021), including the development of Hong Kong Port (HKP) Island of Hong Kong-Zhuhai-Macao Bridge (HZMB), “Airport Tung Chung Link” autonomous transportation system, SKYCITY and the relevant projects. This paper aims to provide members the latest updates on the projects.

### **Background**

2. AAHK put forward the Airport City vision and blueprint in May 2019, which aimed to fully capitalise on the unique geographical advantage of HKIA, capture opportunities arising from various new infrastructural developments in Hong Kong, and integrate and achieve greater synergy between the airport and related industries. The core functions of the airport and related industries are organically and seamlessly integrated into the fabric of the Airport City, unleashing a strong synergy. The various mid- and long-term developments in the blueprint will strengthen HKIA as an international aviation hub and create a new landmark for Hong Kong. HKSAR Government supports the vision of Airport City development. As announced in the Chief Executive’s 2020 Policy Address, the Government has accepted a number of proposals put forward by the AAHK in order to bring HKIA’s function for the economic development of Hong Kong into full play.

3. In December 2020, AAHK announced a series of projects at HKIA that are being implemented progressively as part of the “Airport City” development. The ‘Airport City’ project is expected to complete in phases in 10 years, enhancing the airport’s capacity and functionality, as well as the competitiveness and attractiveness. The relevant projects include the Three-runway System project, air cargo development, smart airport development and ongoing enhancement of airport facilities, with a view to transforming HKIA into a new landmark and propelling the economic development of Hong Kong and the region. The tentative development plan for the HKP Island is shown in **Annex 1** and Paper IDC 14/2021 submitted by AAHK in February 2021.

## **Automated Car Parks**

4. AAHK plans to develop automated car parks on the HKP Island that will provide around 6 000 parking spaces in phases, making use of the latest technology for automated parking system. These include:

### **“Park and Fly” Car Park**

It serves self-drive transfer passengers coming over via the HZMB to fly out of HKIA. “Park and Fly” passengers, after leaving their vehicles in the automated car park, may proceed to the boarding gates directly through the bonded vehicular bridge connected to the SkyPier Terminal (formerly known as the Intermodal Transfer Terminal) located within the restricted area of the airport, without the need to go through Hong Kong’s immigration clearance. This provides a convenient way for transfer passengers to travel to different destinations worldwide. Construction work for the “Park and Fly” Car Park commenced in end-2021.

### **“Park and Visit” Car Park**

It serves self-drive Hong Kong visitors coming over via the HZMB. After leaving their cars in the automated car park, “Park and Visit” visitors may go through immigration clearance procedures at the Passenger Clearance Building of the HKP to enter Hong Kong via Airportcity Link (ACL), and afterwards go from HKP to SKYCITY or to other parts of Hong Kong. Construction work for the “Park and Fly” Car Park commenced in mid-2022.

## **SkyPier Terminal and Bonded Vehicular Bridge**

5. Works of the SkyPier Terminal next to SkyPier and the associated Bonded Vehicular Bridge connecting HKP are undergoing final inspection in phases. Upon completion, it provides convenient land-to-air interchange service for passengers traveling between HKIA and Zhuhai / Macao ports via HZMB. Current progress of the SkyPier Terminal and Bonded Vehicular Bridge is illustrated in **Annex 2**.

6. Some of the land parcels on the HKP Island are also reserved for the development of air cargo logistics and related supporting facilities for the airport community, including data centre, waste management and recycling facilities, power substation, sewage treatment facilities, etc.

## **Airportcity Link (ACL) and Airport Tung Chung Link (ATCL)**

7. AAHK is constructing the ACL bridge on which a vehicular road and a pedestrian walkway will be provided to connect the HKP Island and SKYCITY for

Hong Kong visitors. Works for ACL commenced in early 2022. An autonomous transportation system will be operated on ACL for dedicated airport vehicles. Illustrative designs of ACL are shown in **Annex 3**.

8. AAHK is taking forward the detailed design of ATCL, which will extend the autonomous transportation system of ACL from SKYCITY to Tung Chung town centre, forming a comprehensive transport system connecting to the MTR Tung Chung Station for the convenience of visitors. The ATCL autonomous transportation system will operate on dedicated roads. For the section on Airport Island, AAHK proposes to develop and widen the existing maintenance access along the eastern coast and to provide en-route stops near future development areas, as well as walkways and open spaces. For the section connecting to Tung Chung, autonomous vehicles will operate on a newly built viaduct. The ATCL Tung Chung Station will be constructed on viaduct and serves as the terminus of the autonomous transportation system extension. Entrances will be provided at both ends of the station, connecting the platforms to the footpath at Tat Tung Road for passengers going to MTR Tung Chung Station and public transport interchange. In addition, a section of sewage pipe along Tat Tung Road and Cheung Tung Road will be upgraded for airport development. The upgrade will be carried out together with the ATCL construction works.

9. There will be a viaduct connecting Airport Island and Tung Chung from ATCL Tung Chung Station, along the west side of North Lantau Highway, spanning over Tung Chung Waterfront Road and Tung Chung Promenade. Part of the existing waterfront area will be occupied as work sites to support the construction of marine viaducts. AAHK will request contractors to maintain the operation of pedestrian passage during construction. All affected facilities will be re-provisioned after completion of works.

10. AAHK has conducted the Environmental Impact Assessment (EIA) study for ATCL project. The result showed that the statutory requirements are met after implementation of the proposed mitigation measures. The EIA report has been scheduled to upload to the website of Environmental Protection Department for public inspection.

11. It is anticipated that the ATCL project will be gazetted under Roads (Works, Use and Compensation) Ordinance at the end of this year or early next year. Works will commence after completion of statutory procedures and scheme authorization. Tentative commencement date for ATCL construction will be in the second half of 2025, and completion by 2028 at the earliest. In addition, the sewerage upgrading works at Tat Tung Road and Cheung Tung Road will be gazetted around the end of this year under Water Pollution Control (Sewerage) Regulation.

12. The ATCL project will strengthen the transport connection between airport and Tung Chung for the convenience of residents and passengers using the airport,

HZMB and adjacent commercial and hotel facilities. Illustrative designs of ATCL are shown in **Annex 4**.

### **SKYCITY Pier and Waterfront Facilities**

13. AAHK plans to develop SKYCITY pier and berthing facilities at the waterfront of SKYCITY development to further enhance the function of HKIA, synergize developments in HKIA, HKP and SKYCITY and promote water tourism. Beautification works are proposed near the pier to provide a promenade near the waterfront in future.

14. It is anticipated that the SKYCITY Pier and berthing facilities project will be gazetted under Foreshore and Seabed (Reclamations) Ordinance at the end of this year or early next year. Works will commence after completion of statutory procedures and scheme authorization.

15. **Annex 5** shows the location of the proposed SKYCITY Pier and promenade.

### **SKYCITY and Asia-World Expo (AWE) Phase 2 Development**

16. The SKYCITY Development is a crucial part of the long-term development of HKIA. It acts as a key component of AAHK's vision to transform HKIA from a "city airport" to an "Airport City". Development in phases, SKYCITY will create synergy with other Lantau's attractions, generate business and employment opportunities, and promote tourism. The initial phase of the SKYCITY Development includes a hotel at Site A1a, and an integrated retail, dining and entertainment development, and office towers in Site A2 and Site A3. AAHK provided details of the SKYCITY development in Paper IDC 46/2021 in July 2021. Please refer to **Annex 6** for the illustrated design of SKYCITY.

17. The hotel development at SKYCITY Site A1a was completed and operation commenced in end-2021. Retail, dining and entertainment development, and office towers at Site A2 and Site A3 are being completed progressively, with operation commencement from 2022 to 2025 in phases.

18. AAHK has started planning for the AWE Phase 2 Development. The site of AWE Phase 2 measures approximately 52 000 square metres. Upon the completion of AWE Phase 2, it will be one of the largest indoor performance venues in Asia, and the total floor area of the exhibition facilities will be increased to 100,000 square metres. The site of AWE Phase 2 is now temporarily used for "The North Lantau Hospital Hong Kong Infection Control Centre". After removal of these facilities, AAHK will start the development of AWE Phase 2.

## **Airport Island East Coast Support Area**

19. AAHK plans to utilize the land at the east coast of Airport Island for the development of offices, hotels and airport supporting facilities for future airport planning and implementation of the “Airport City” vision.

### **Progress**

20. AAHK is carrying out the above projects, including the necessary statutory procedures, and will bring them into service in phases.

### **Advice Sought**

21. Members are invited to note the above.

Airport Authority Hong Kong  
September 2023

## Latest Development of Hong Kong Port Island of Hong Kong-Zhuhai-Macao Bridge

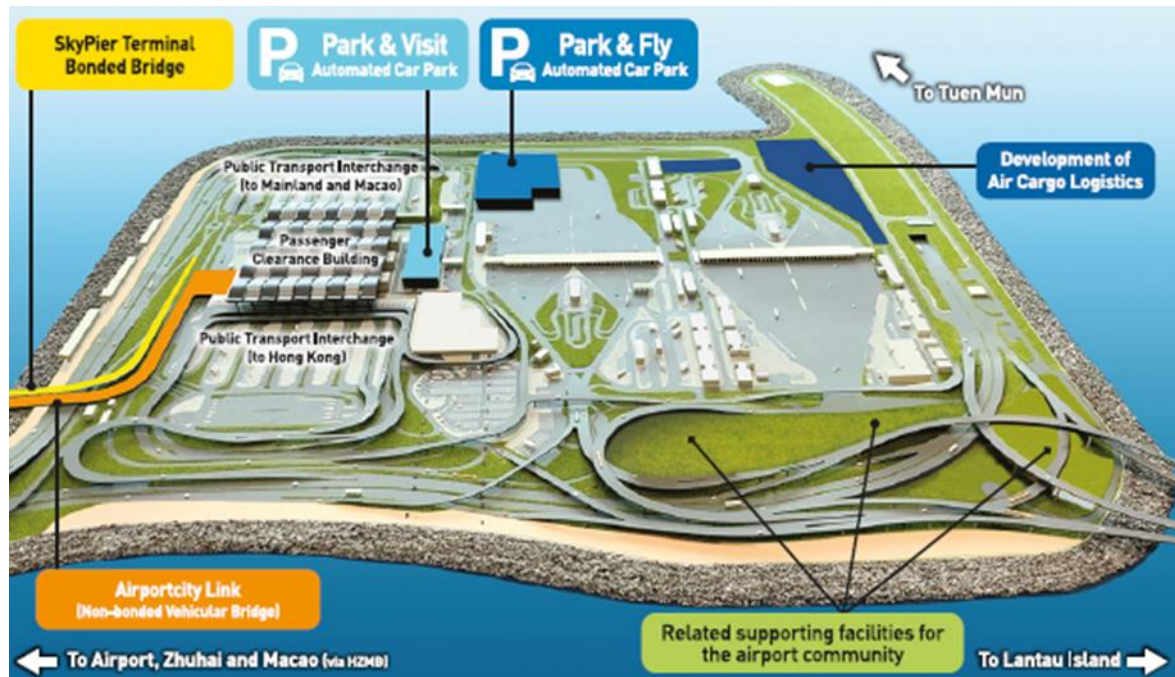

**SkyPier Terminal and Bonded Vehicular Bridge**





**Airportcity Link – Illustrated design of vehicular bridge, pedestrian walkway and observation deck**





## Alignment of Airport Tung Chung Link

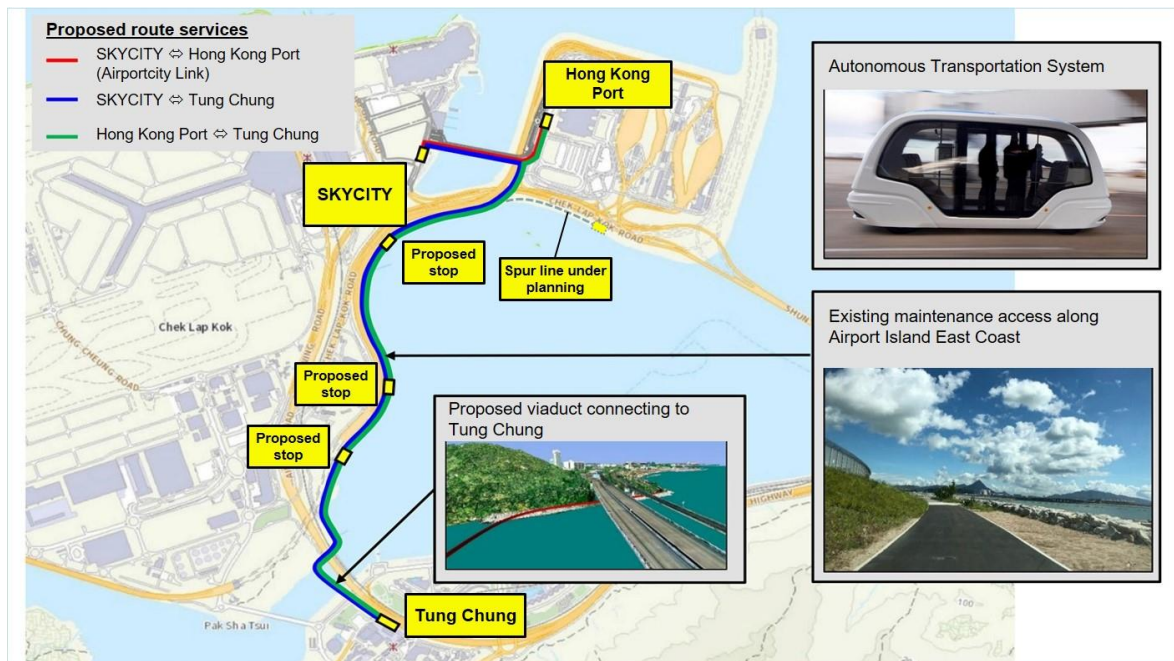

- Total length: approximately 3.8km
- Comprising at-grade roads, marine viaduct and land viaducts
- Operated by electric-powered autonomous transportation system
- Anticipated journey time
  - SKYCITY <-> HKP : approximately 2 to 3 mins
  - HKP / SKYCITY <-> Tung Chung Town Centre : approximately 8 to 10 mins

**Proposed location of SKYCITY developments, SkyPier Terminal and promenade**

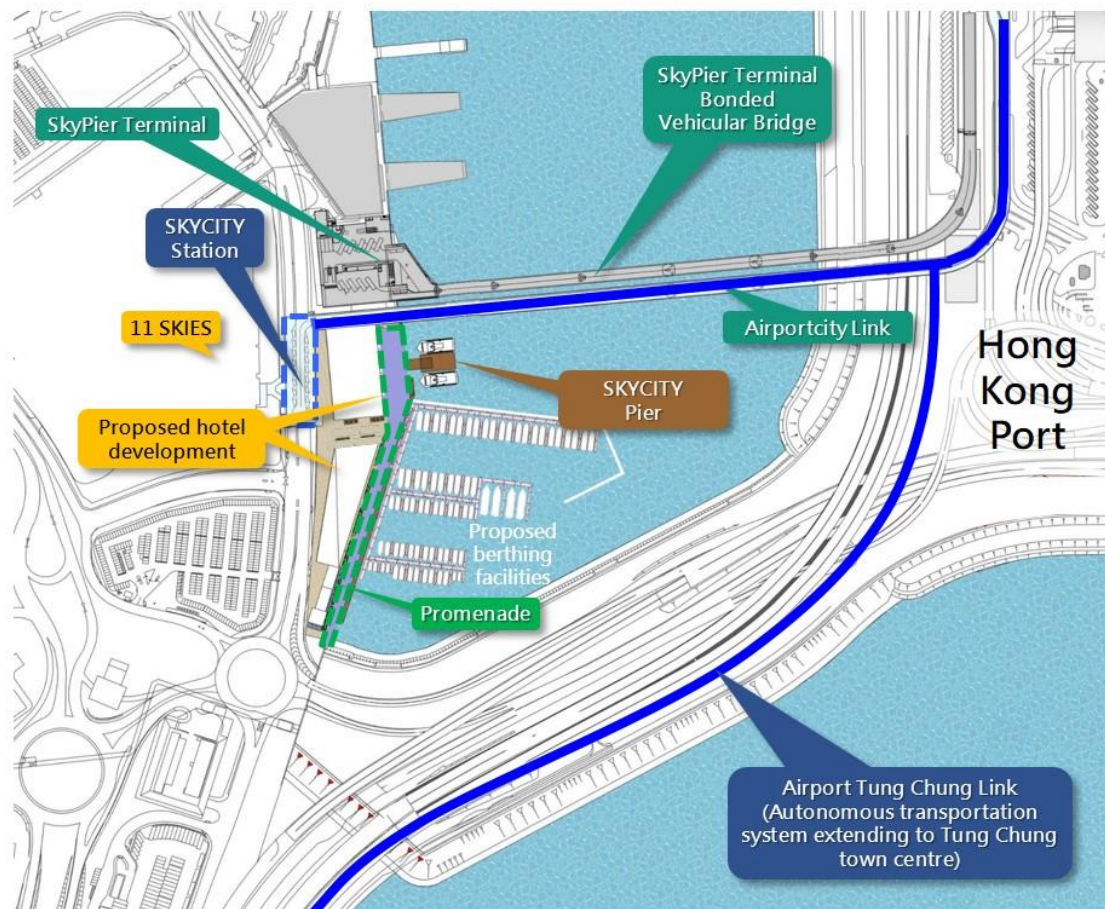

**Overall planning of SKYCITY development**

