

這是1990年8月17日在憲報公布的中期發展審批地區圖編號IDPA/NE-LYT/17沒有涵蓋的範圍，但已包括在龍躍頭及軍地南分區計劃大綱圖編號S/NE-LYT/3的規劃區內。
 AREA NOT FALLING WITHIN THE BOUNDARIES OF THE IDPA PLAN No. IDPA/NE-LYT/17 PUBLISHED IN THE GAZETTE ON 17.8.1990 BUT INCLUDED IN THE PLANNING SCHEME AREA ON THE DRAFT LUNG YEUK TAU AND KWAN TEI SOUTH OUTLINE ZONING PLAN No. S/NE-LYT/3.

圖例 LEGEND

擬議皇后山擴展用地公營房屋發展計劃：
 PROPOSED QUEEN'S HILL EXTENSION DEVELOPMENT FOR PUBLIC HOUSING DEVELOPMENT:

A1 由「住宅(乙類)」地帶改劃為「住宅(甲類)1」地帶
 AREA TO BE REZONED FROM "RESIDENTIAL (GROUP B)" TO "RESIDENTIAL (GROUP A) 1"

A2 由「住宅(甲類)」地帶改劃為「住宅(甲類)1」地帶
 AREA TO BE REZONED FROM "RESIDENTIAL (GROUP A)" TO "RESIDENTIAL (GROUP A) 1"

反映崇謙堂墳場現有用途：
 REFLECT EXISTING USE OF SUNG HIM TONG CEMETERY:

B 從鶴藪分區計劃大綱圖範圍中剔除並納入龍躍頭及軍地南分區計劃大綱圖，繼而由「農業」地帶及「綠化地帶」改劃為「其他指定用途」註明「墳場」地帶
 AREA TO BE EXCISED FOR INCORPORATION INTO THE LUNG YEUK TAU & KWAN TEI SOUTH OUTLINE ZONING PLAN AND TO BE REZONED FROM "AGRICULTURE" AND "GREEN BELT" TO "OTHER SPECIFIED USES" ANNOTATED "CEMETERY"

界線只作識別用
 BOUNDARY FOR IDENTIFICATION PURPOSE ONLY

本摘要圖於2021年9月29日擬備，所根據的資料為於2006年10月17日核准的分區計劃大綱圖編號S/NE-HT/5及2016年2月2日核准的分區計劃大綱圖編號S/NE-LYT/17
 EXTRACT PLAN PREPARED ON 29.9.2021 BASED ON OUTLINE ZONING PLAN No. S/NE-HT/5 APPROVED ON 17.10.2006 AND OUTLINE ZONING PLAN No. S/NE-LYT/17 APPROVED ON 2.2.2016

位置圖 LOCATION PLAN

龍躍頭及軍地南分區計劃大綱核准圖編號S/NE-LYT/17及
 鶴藪分區計劃大綱核准圖編號S/NE-HT/5的擬議修訂
 PROPOSED AMENDMENTS TO
 THE APPROVED LUNG YEUK TAU & KWAN TEI SOUTH OUTLINE ZONING PLAN No. S/NE-LYT/17 AND
 THE APPROVED HOK TAU OUTLINE ZONING PLAN No. S/NE-HT/5

SCALE 1:7 500 比例尺

米 METRES 100 0 100 200 300 400 500 600 700 米 METRES

規劃署
 PLANNING DEPARTMENT

參考編號
 REFERENCE No.
 M/NE/21/16

圖 PLAN
 1

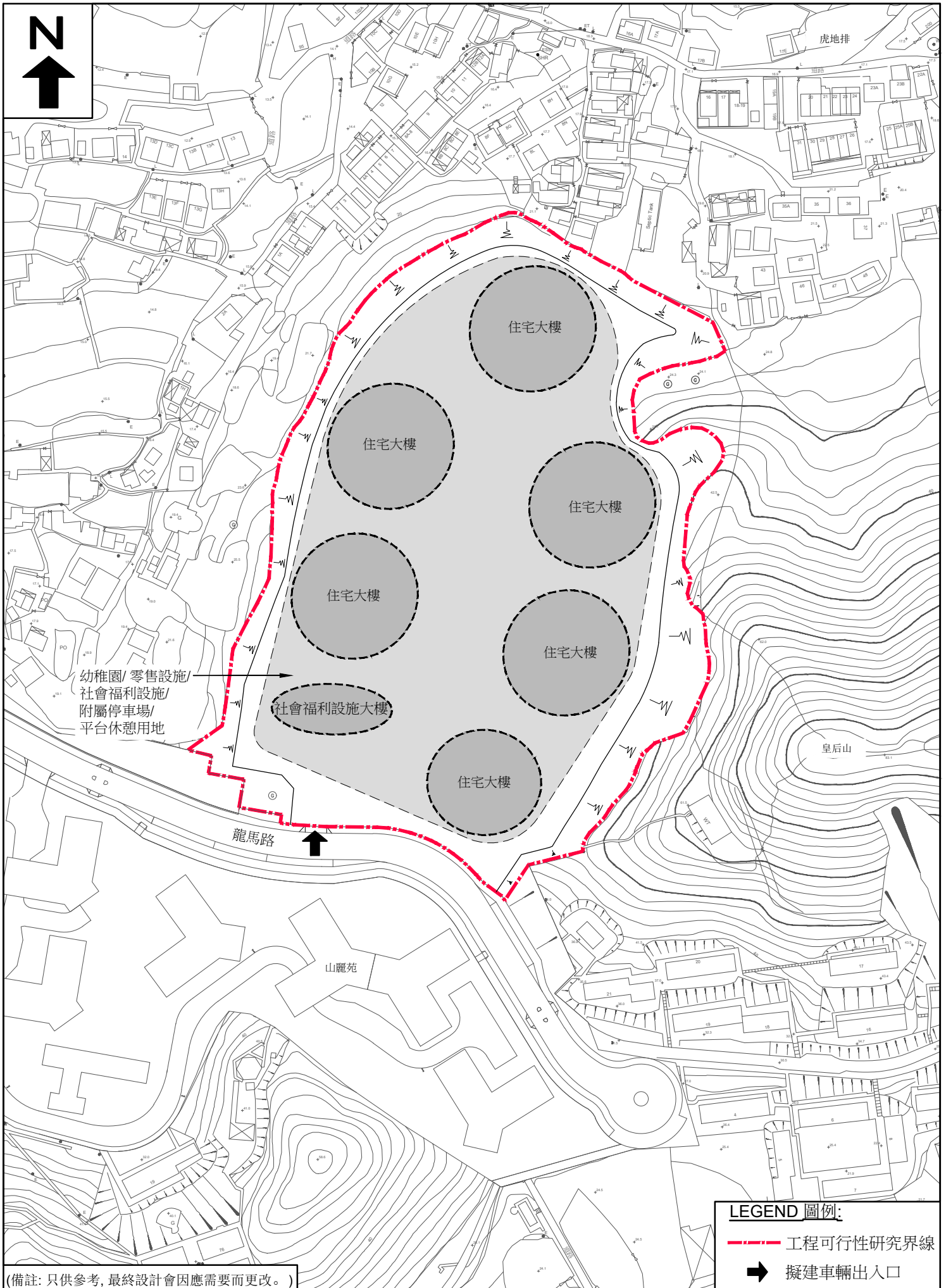

(備註: 只供參考, 最終設計會因應需要而更改。)