

LOCATION : Clear Water Bay Road near Silverstrand Beach Road, Sai Kung

DRAWING NO. : NE140847.01 (E12P11C,E12P11D)

SCALE : 1 : 500 (A4)

(備註：此圖則只供參閱，並非最終版本)

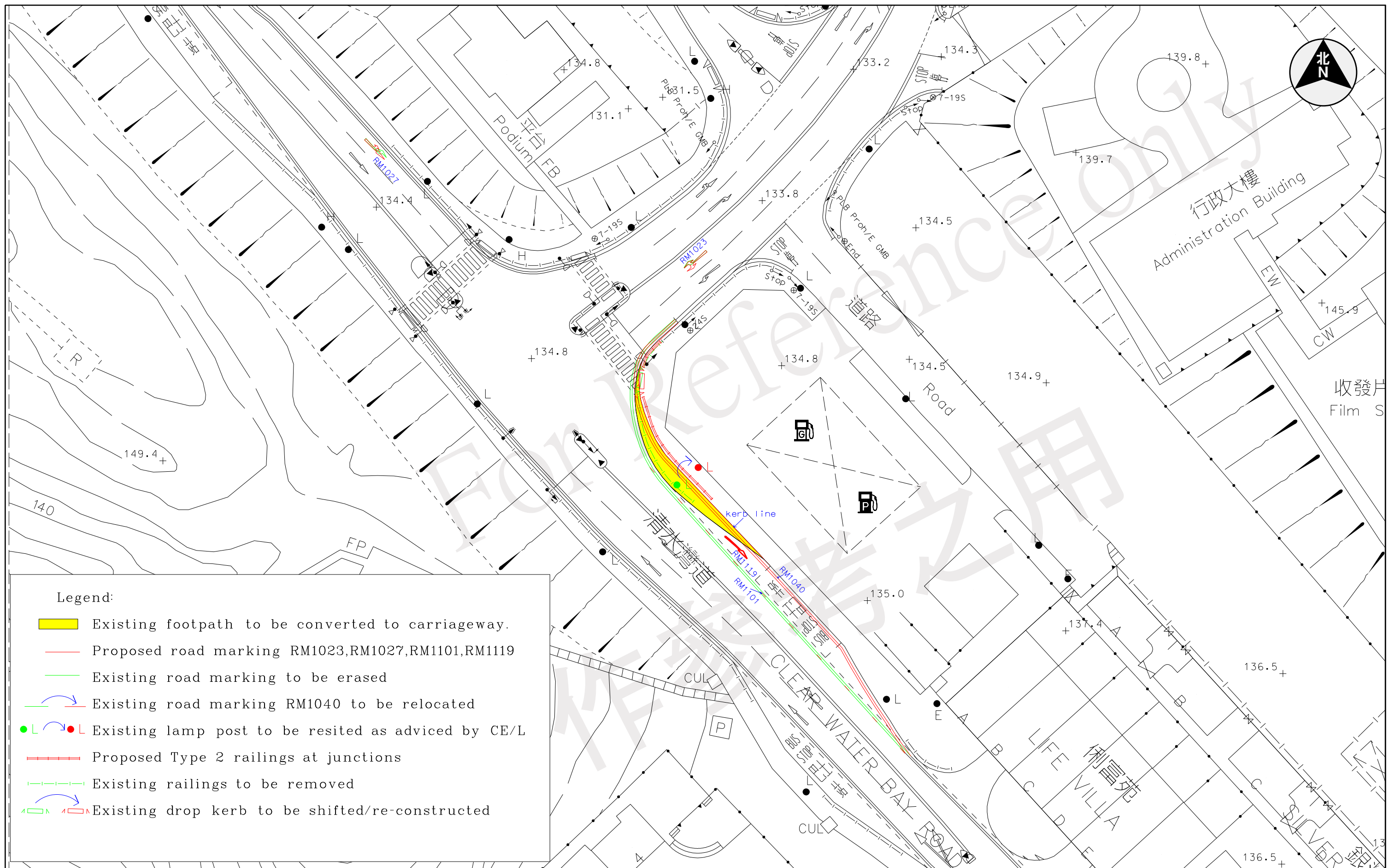

Legend:

- Existing footpath to be converted to carriageway.
- Proposed road marking RM1023, RM1027, RM1101, RM1119
- Existing road marking to be erased
- Existing road marking RM1040 to be relocated
- L Existing lamp post to be resited as advised by CE/L
- Proposed Type 2 railings at junctions
- Existing railings to be removed
- Existing drop kerb to be shifted/re-constructed

LOCATION : Clear Water Bay Road near Ngan Ying Road

DRAWING NO. : NE140857.01 (E12P11A)

SCALE : 1 : 500 (A3)