

**Broad Development Parameters of the Applied Use/Development
in respect of Application No. A/TW/534**

關乎申請編號 A/TW/534 的擬議用途/發展的概括發展規範

Application No. 申請編號	A/TW/534		
Location/address 位置/地址	Workshop No. 3, 20/F, Sunwise Industrial Building, Nos. 16-26 Wang Wo Tsai Street, Tsuen Wan 荃灣橫窩仔街 16-26 號順力工業大廈 20 樓 3 號工場		
Site area 地盤面積	- sq. m 平方米		
Plan 圖則	Approved Tsuen Wan Outline Zoning Plan No. S/TW/35 荃灣分區計劃大綱核准圖編號 S/TW/35		
Zoning 地帶	"Comprehensive Development Area (5)" 「綜合發展區(5)」		
Applied use/ development 申請用途/發展	Office (Audio-visual Recording Studio) 辦公室(影音錄製室)		
Gross floor area and/or plot ratio 總樓面面積及/ 或地積比率		sq. m 平方米	Plot ratio 地積比率
	Domestic 住用	-	-
	Non-domestic 非住用	About 約 64	-
No. of block 幢數	Domestic 住用	-	
	Non-domestic 非住用	-	
	Composite 綜合用途	-	
Building height/No. of storeys 建築物高度/ 層數	Domestic 住用	-	m 米
		-	mPD 米(主水平基準上)
		-	Storey(s) 層
	Non-domestic 非住用	-	m 米
		-	mPD 米(主水平基準上)
		-	Storey(s) 層
	Composite 綜合用途	-	m 米
		-	mPD 米(主水平基準上)
		-	Storey(s) 層
Site coverage 上蓋面積	-		

No. of units 單位數目	1 Workshop 工作室		
Open space 休憩用地	Private 私人	-	sq. m 平方米
	Public 公眾	-	sq. m 平方米
No. of parking spaces and loading / unloading spaces 停車位及上落客貨 車位數目	-		

* 有關資料是為方便市民大眾參考而提供。對於所載資料在使用上的問題及文義上的歧異，城市規劃委員會概不負責。若有任何疑問，應查閱申請人提交的文件。

The information is provided for easy reference of the general public. Under no circumstances will the Town Planning Board accept any liabilities for the use of the information nor any inaccuracies or discrepancies of the information provided. In case of doubt, reference should always be made to the submission of the applicant.

Submitted Plans, Drawings and Documents 提交的圖則、繪圖及文件		
	<u>Chinese</u> 中文	<u>English</u> 英文
<u>Plans and Drawings 圖則及繪圖</u>		
Master layout plan(s)/Layout plan(s) 總綱發展藍圖／布局設計圖	<input checked="" type="checkbox"/>	<input type="checkbox"/>
Block plan(s) 樓宇位置圖	<input checked="" type="checkbox"/>	<input type="checkbox"/>
Floor plan(s) 樓宇平面圖	<input checked="" type="checkbox"/>	<input type="checkbox"/>
Sectional plan(s) 截視圖	<input type="checkbox"/>	<input type="checkbox"/>
Elevation(s) 立視圖	<input type="checkbox"/>	<input type="checkbox"/>
Photomontage(s) showing the proposed development 顯示擬議發展的合成照片	<input type="checkbox"/>	<input type="checkbox"/>
Master landscape plan(s)/Landscape plan(s) 園境設計總圖／園境設計圖	<input type="checkbox"/>	<input type="checkbox"/>
Others (please specify) 其他（請註明）	<input type="checkbox"/>	<input type="checkbox"/>
<u>Reports 報告書</u>		
Planning Statement / Justifications 規劃綱領 / 理據	<input type="checkbox"/>	<input type="checkbox"/>
Environmental assessment (noise, air and/or water pollutions) 環境評估（噪音、空氣及／或水的污染）	<input type="checkbox"/>	<input type="checkbox"/>
Traffic impact assessment (on vehicles) 就車輛的交通影響評估	<input type="checkbox"/>	<input type="checkbox"/>
Traffic impact assessment (on pedestrians) 就行人的交通影響評估	<input type="checkbox"/>	<input type="checkbox"/>
Visual impact assessment 視覺影響評估	<input type="checkbox"/>	<input type="checkbox"/>
Landscape impact assessment 景觀影響評估	<input type="checkbox"/>	<input type="checkbox"/>
Tree Survey 樹木調查	<input type="checkbox"/>	<input type="checkbox"/>
Geotechnical impact assessment 土力影響評估	<input type="checkbox"/>	<input type="checkbox"/>
Drainage impact assessment 排水影響評估	<input type="checkbox"/>	<input type="checkbox"/>
Sewerage impact assessment 排污影響評估	<input type="checkbox"/>	<input type="checkbox"/>
Risk Assessment 風險評估	<input type="checkbox"/>	<input type="checkbox"/>
Others (please specify) 其他（請註明）	<input type="checkbox"/>	<input type="checkbox"/>
Note: May insert more than one 「✓」. 註：可在多於一個方格內加上「✓」號		

Note: The information in the Gist of Application above is provided by the applicant for easy reference of the general public. Under no circumstances will the Town Planning Board accept any liabilities for the use of the information nor any inaccuracies or discrepancies of the information provided. In case of doubt, reference should always be made to the submission of the applicant.

註：上述申請摘要的資料是由申請人提供以方便市民大眾參考。對於所載資料在使用上的問題及文義上的歧異，城市規劃委員會概不負責。若有任何疑問，應查閱申請人提交的文件。

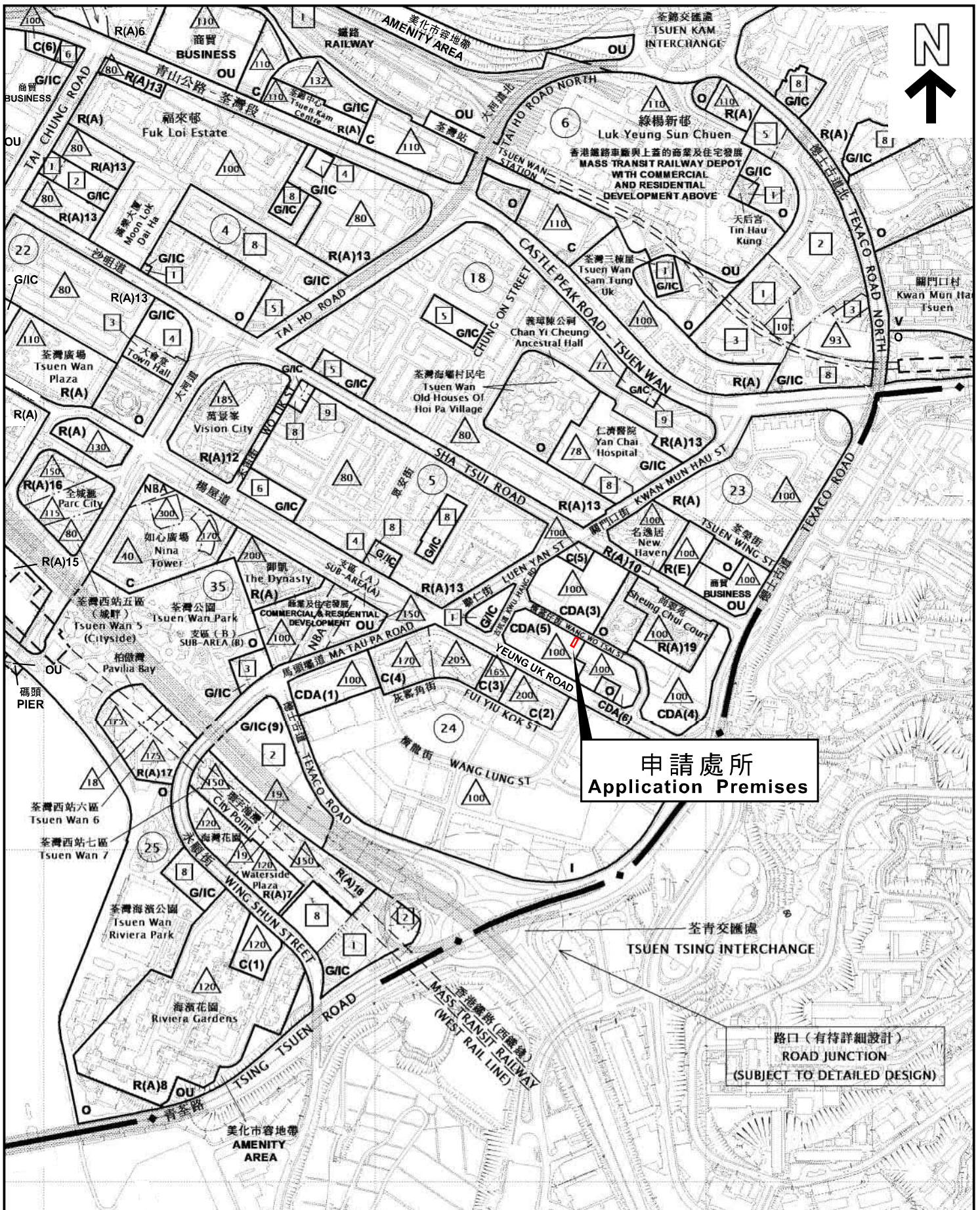

申請處所
Application Premises

路口 (有符詳細設計)
ROAD JUNCTION
(SUBJECT TO DETAILED DESIGN)

位置圖 LOCATION PLAN

本摘要圖於2022年8月3日擬備，
所根據的資料為於2022年2月8日
核准的分區計劃大綱圖編號S/TW/35

EXTRACT PLAN PREPARED ON
3.8.2022 BASED ON OUTLINE ZONING
PLAN No. S/TW/35 APPROVED ON
8.2.2022

申請處所界線只作識別用
APPLICATION PREMISES BOUNDARY
FOR IDENTIFICATION PURPOSE ONLY

參考編號
REFERENCE No.

A/TW/534



申請處所
Application Premises

平面圖 SITE PLAN

本摘要圖於2022年8月3日擬備，
所根據的資料為測量圖編號7-SW-16C

EXTRACT PLAN PREPARED ON
3.8.2022 BASED ON SURVEY SHEET
No. 7-SW-16C

申請處所界線只作識別用
APPLICATION PREMISES BOUNDARY
FOR IDENTIFICATION PURPOSE ONLY

參考編號
REFERENCE No.

A/TW/534

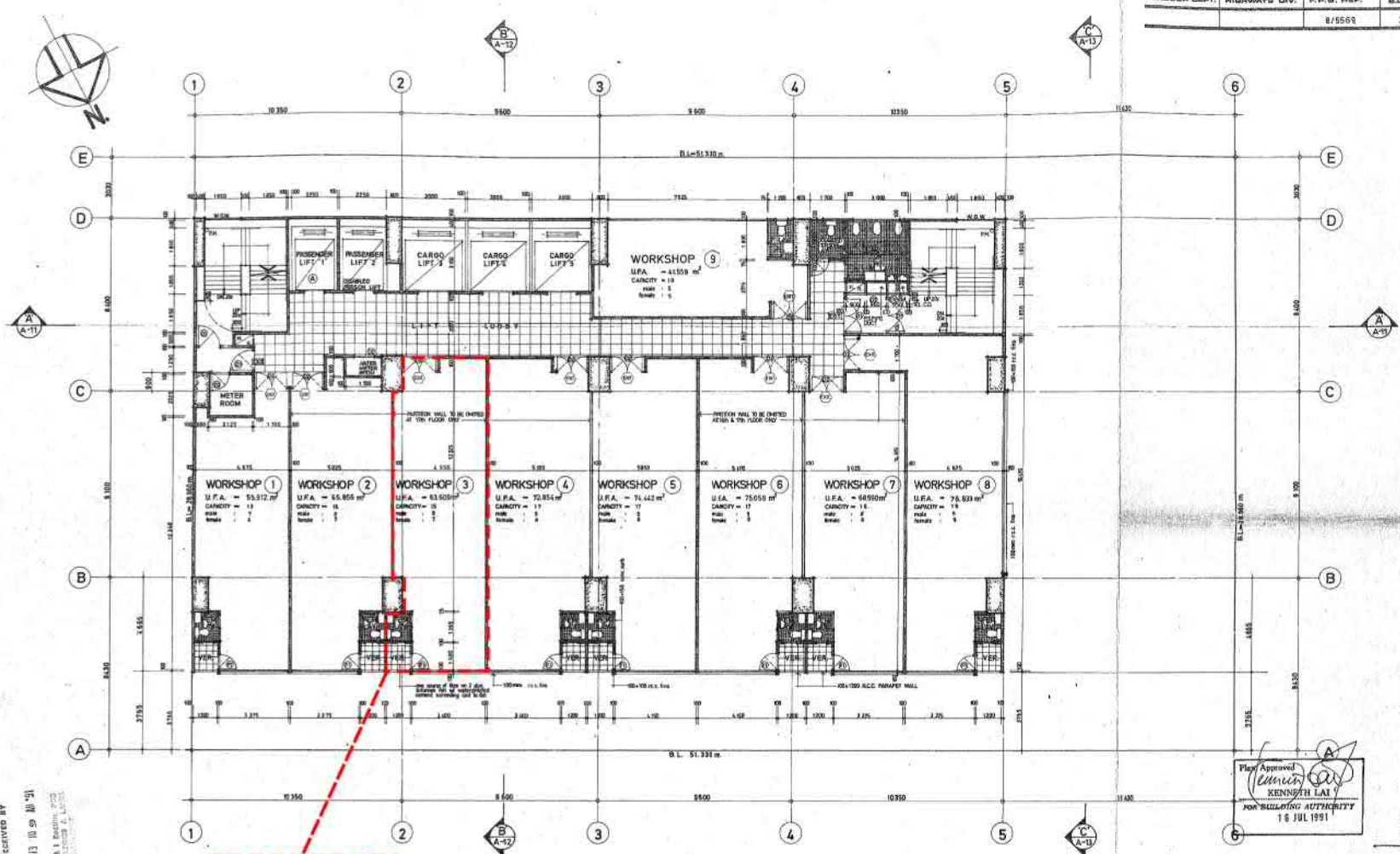

RECEIVED BY
 JUL 13 10 59 AM '91
 B.S.I. Building Dept
 BUILDING & LANDS
 DEPARTMENT

申請處所
 Application Premise

15th TO 25th FLOOR PLAN

NOTE: 1. SPRINKLER SYSTEM TO BE PROVIDED.
 2. FLOOR IMPOSED LOAD = 75 kPa.
 3. IN EVERY NOTICEABLE WORKSPACE ILLUSTRATED NOTICES BEARING THE WORD EXIT IN ENGLISH AND CHINESE SHALL BE PROVIDED AT EACH EXIT FROM THE WORKSPACE. THE FORM OF THE NOTICE SHALL BE AS SET OUT IN THE ATTACHED FORM AND THE HEIGHT OF THE LETTERING SHALL BE NOT LESS THAN 100mm AND BE RED ON A WHITE BACKGROUND.

Plan Approved
 KENNETH LAI
 FOR BUILDING AUTHORITY
 16 JUL 1991

11 JUL 1991

B. L. D.

NOTES:

This drawing and design are copyright of the authorized person. No person may be reproduced without the written permission. Any person who reproduces this drawing without the written permission shall be liable to the extent of the law. This drawing shall be read in conjunction with specifications & conditions of contract.

DATE	AMENDMENT
17-4-88	A. BOUNDARY LINE DIMENSION REVISED. B.C. COLUMN SIZE REVISED. C. 100mm RC WALL INSIDE LIFT SHAFT TO BE DELETED.
25-9-88	D. GROSS FLOOR AREA REVISED. E. NO. OF WORKSHOP INCREASED. F. METER RM & WATER METERS RM RELAYED.
8-1-92	G. CHECKED TO BE ISSUED.

NO.	DESCRIPTION	DATE	BY	CHECKED
01	DESIGN	17-12-1987	Y. W. CHAN	Y. W. CHAN
02	DRWN		H. CHAN	Y. W. CHAN
03	CHKD		Y. W. CHAN	Y. W. CHAN
04	SCALE		1 : 500	
05	DATE	17-12-1987		

SUN HUNG KAI ENGINEERING CO. LTD.
 SUN HUNG KAI CONSULTING, HONGKONG, H. K.

JOB:
 PROPOSED INDUSTRIAL BUILDING
 ON D.D. 443, LOT No. 459 R.P.S. & A
 16-26, WANG WO TSAI STREET,
 TSUEN WAN, NEW TERRITORIES

DWG.	JOB NO.	A
15th TO 25th FL PLAN		B
		C
		D
		E
		F